

# 160.601024A - Brass slide bar with 1/2" Wall Supply Elbow With Adjustable Slide On Installation

## Installation Manual

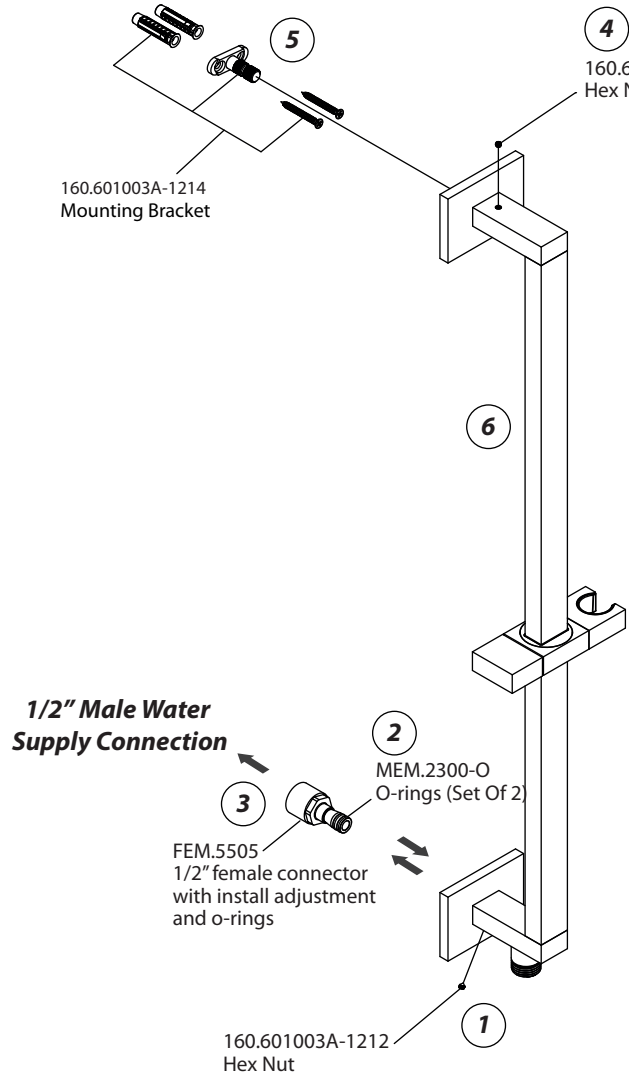

**1.** Loosen & remove two hex screws using 1.5mm Allen key .

Then slide the bar out and separate from FEM.5505

**2.** Ensure O-rings are not damaged on FEM.5505

**3.** Ensure the FEM.5505 is secured into the male 1/2" wall supply connection.

**4.** Loosen the hex nut and remove the Mounting Bracket.

**5.** Install mounting bracket into the wall at the right location using the screws provided.

**6.** Insert the slide bar and tighten all hex screws

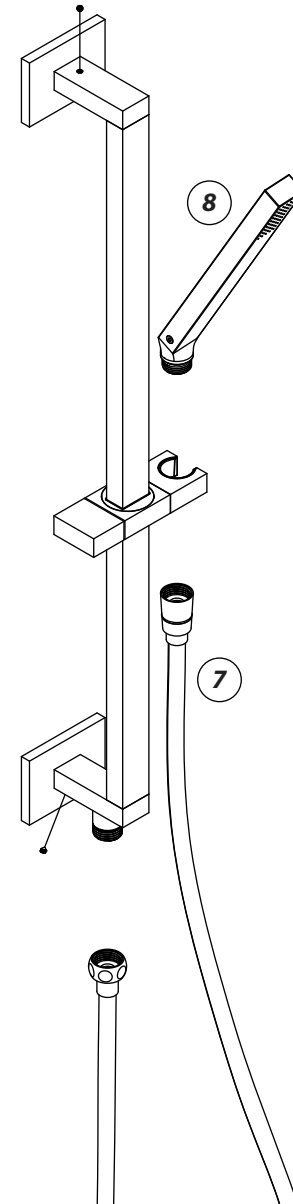

**7.** Tighten hose into the bottom 1/2" elbow outlet connection

**8.** Tighten the hand held shower into the other end of the hose and insert into the holder.

**isenberg**  
innovation+design

160.601024A

Ver 2.53