

Installation Manual

3/4" Thermostatic Valve With 2 or 3 Output Diverter

HORIZONTAL or VERTICAL Installation

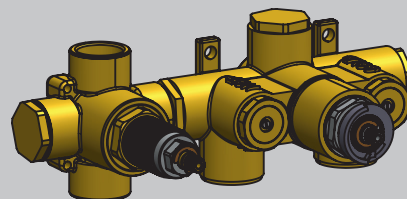
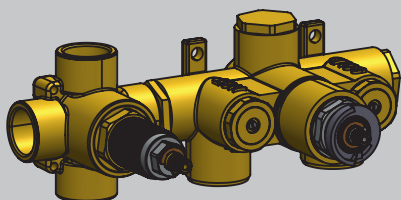
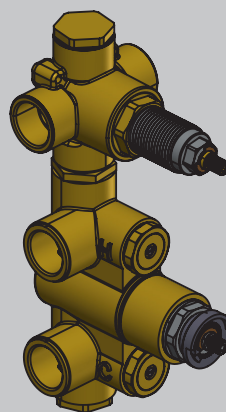
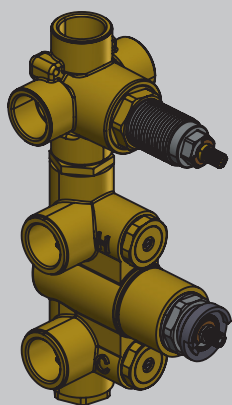

TVH.2705F
3 OUTPUT

TVH.2717F
2 OUTPUT

BEFORE YOU BEGIN

- You must observe all local plumbing laws and codes.
- Do not install this valve if it does not meet local plumbing codes.
- Shut off the main water supply.

TABLE OF CONTENTS

• Operating Specifications	1
• Valve Installation And Tolerance	
• Cut-Out Dimensions	1
• Rough In Specification	2
• Connecting The Supply & Output Lines	3
• Finished Tile Position	7
• Using The Supply Stops	8
• Flushing The Valve	9
• Installing The Trim	10
• Replacing The Thermostatic Cartridge	16
• Replacing Diverter Cartridge	17
• Installing The Extension Kit	18

NOTICE TO HOMEOWNER

- We recommend that this product is installed by a qualified professional plumber.
- Please check this product immediately to ensure that it has not been damaged and is complete. Before installation, please make sure this product is the correct model and you have all the parts required for installation and use.
- Please flush the water system to ensure that no metal swarf, solder, and other impurities can enter the product.
- Turn off water supply before commencing work.
- Please read these instructions carefully and retain for future reference.

OPERATING SPECIFICATIONS

WATER TEMPERATURE



This product is to be used with water at a temperature range of 40°F - 120°F ONLY!

WATER PRESSURE



This product is to be used with a water pressure range of 15 PSI to 80 PSI ONLY

If water pressure is greater than 80 PSI install a pressure reducing valve (PRV)

This valve meets or exceeds ANSI A112.18.1 and ASSE 1016
This valve is certified by IAPMO

CUT OUT DIMENSIONS

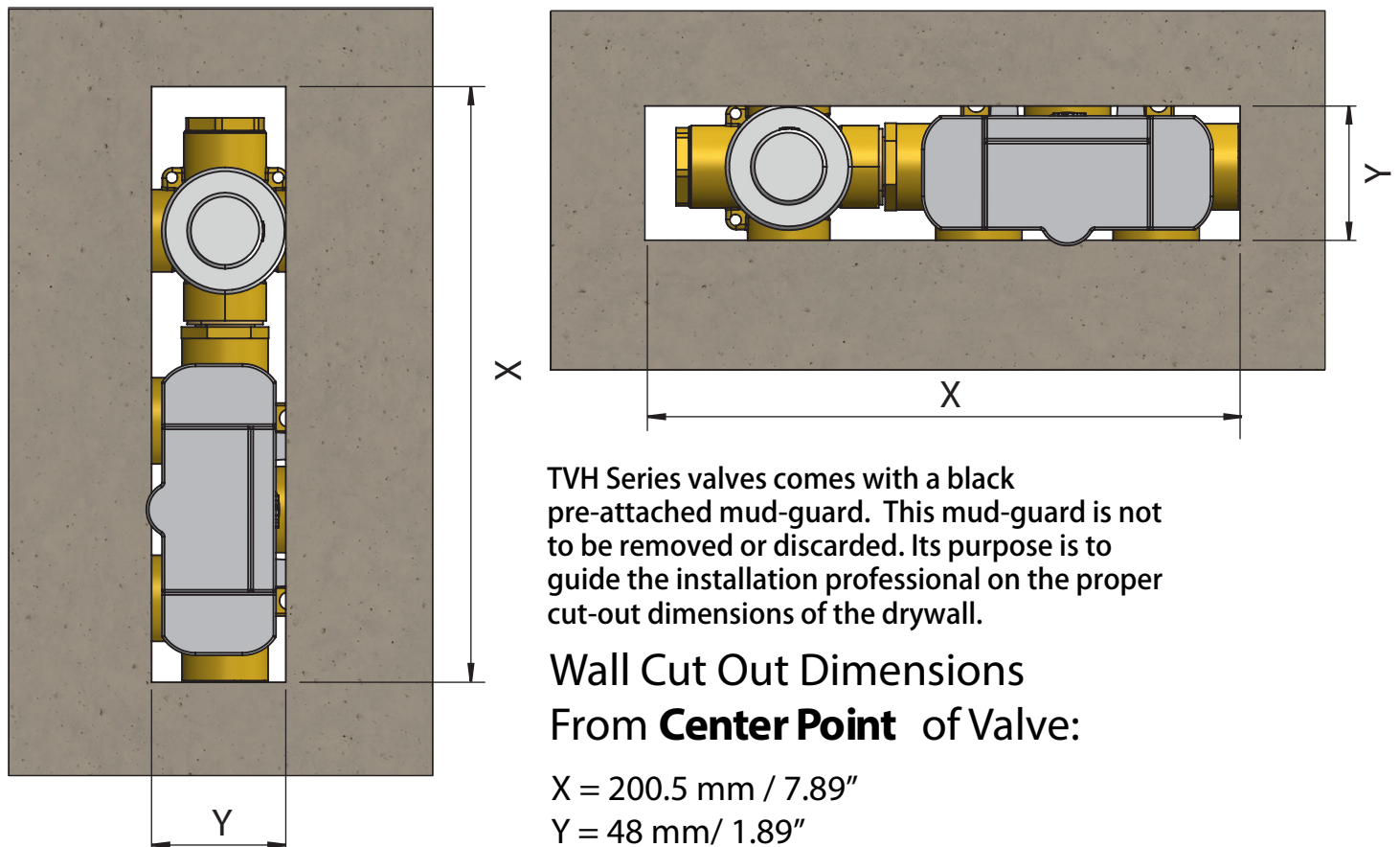

Shown Here: Vertical & Horizontal Installation.

ROUGH IN SPECIFICATION

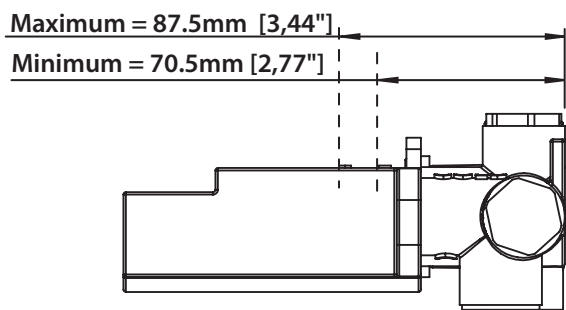

[Horizontal View]

The distance between back of the valve to the finished tile surface should be between 2.77" and 3.44" inches

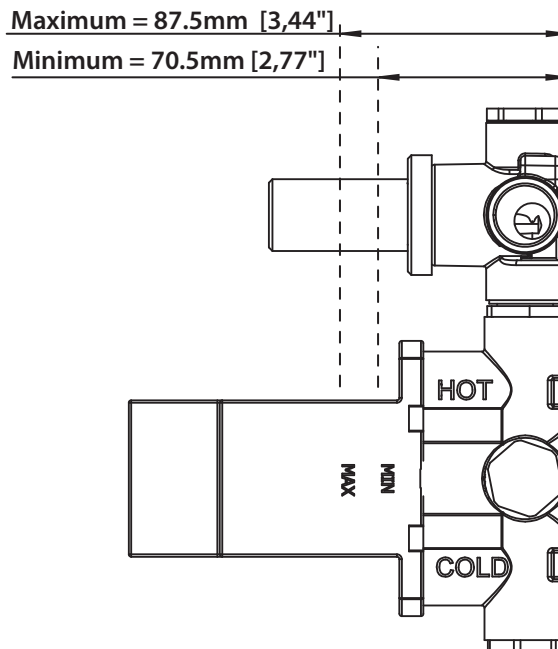

[Vertical View]

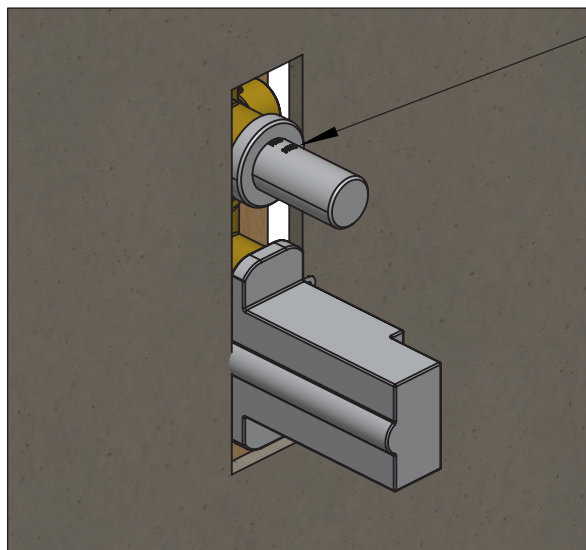

Finished tile should fall between Min & max.

If valve is installed too deep into the wall, extensions are available.

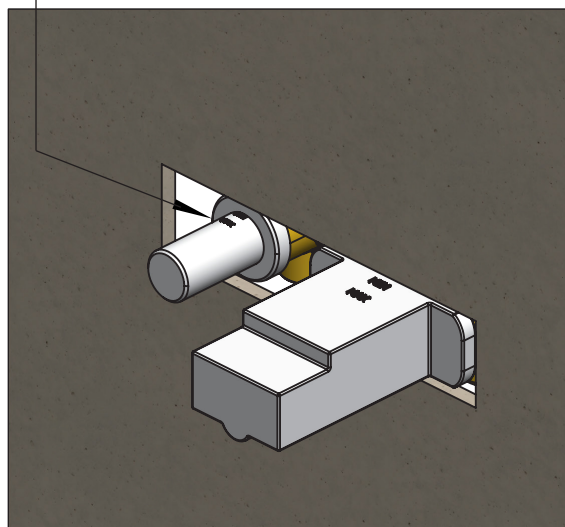

CONNECTING THE SUPPLY & OUTPUT LINES

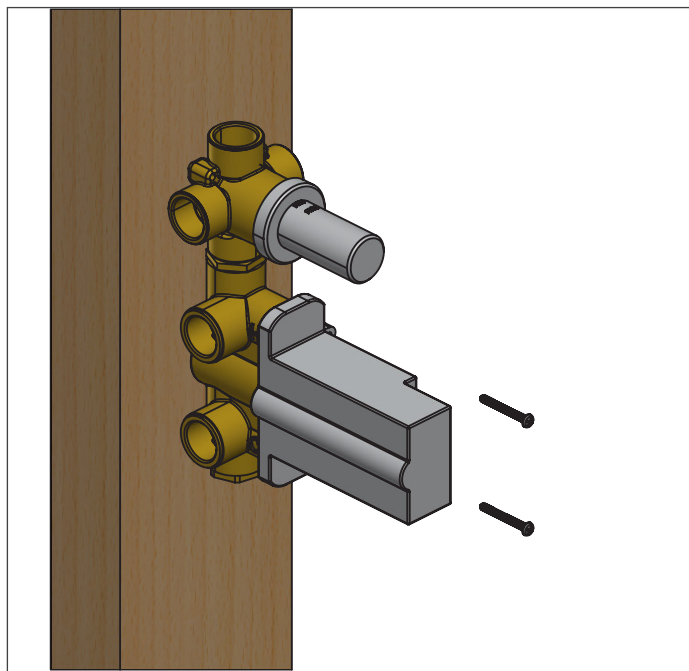
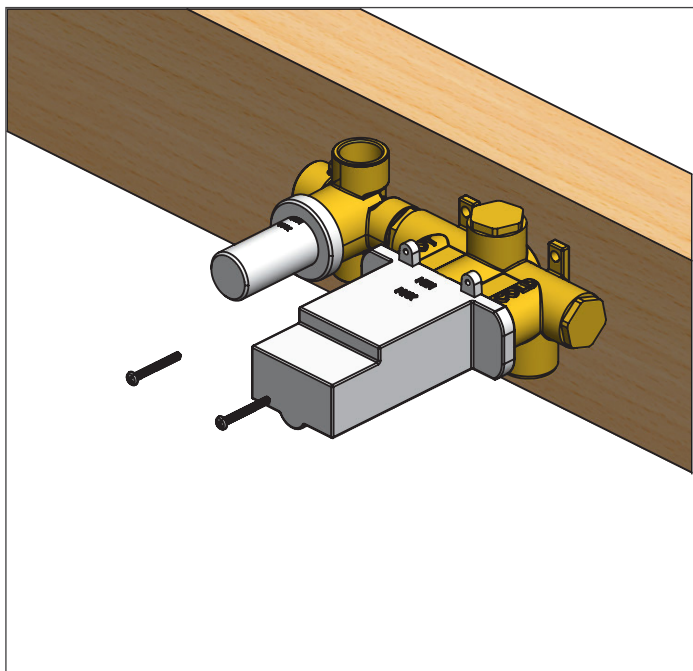

[Horizontal & Vertical View] - Fix Valve on wooden plank

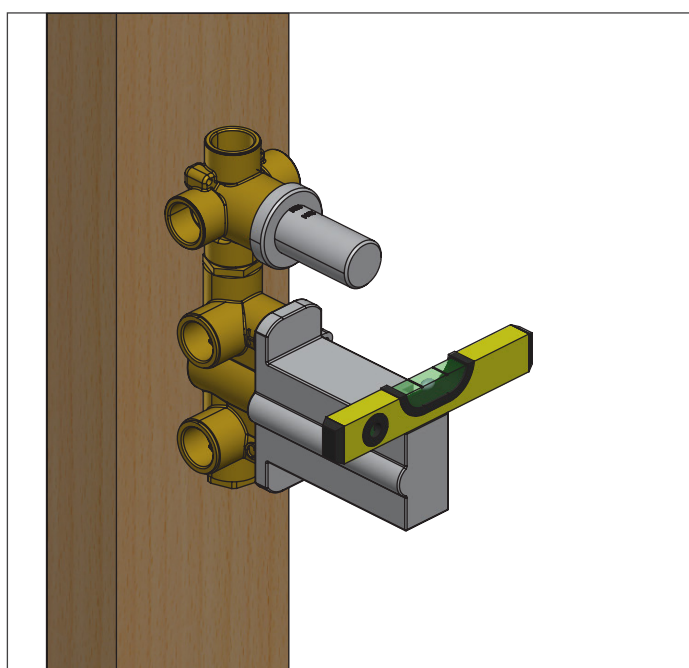
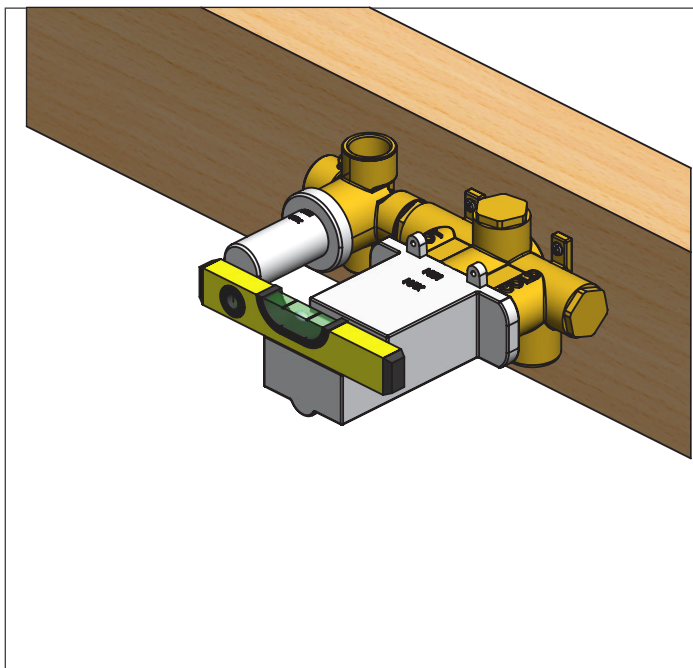

[Horizontal & Vertical View] - Level Valve

CONNECTING THE SUPPLY & OUTPUT LINES

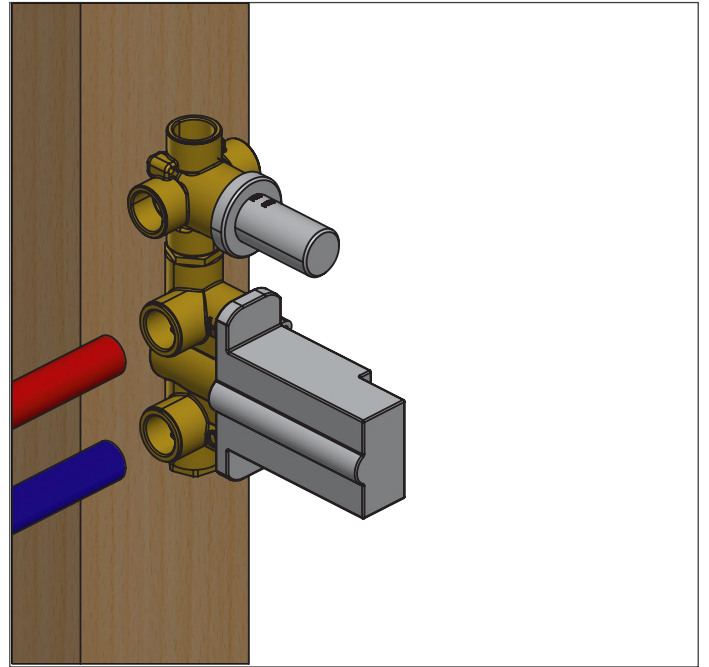
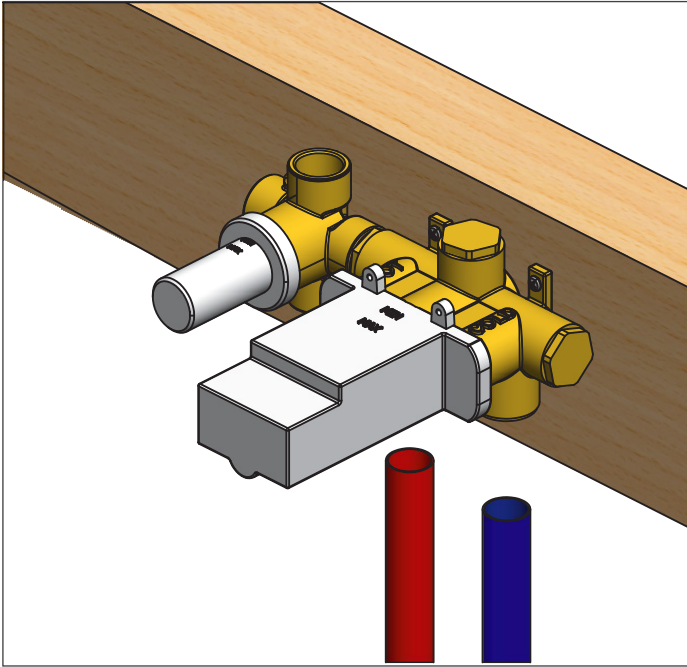

[Horizontal & Vertical View] - Attach hot and cold lines

CONNECTING THE SUPPLY & OUTPUT LINES

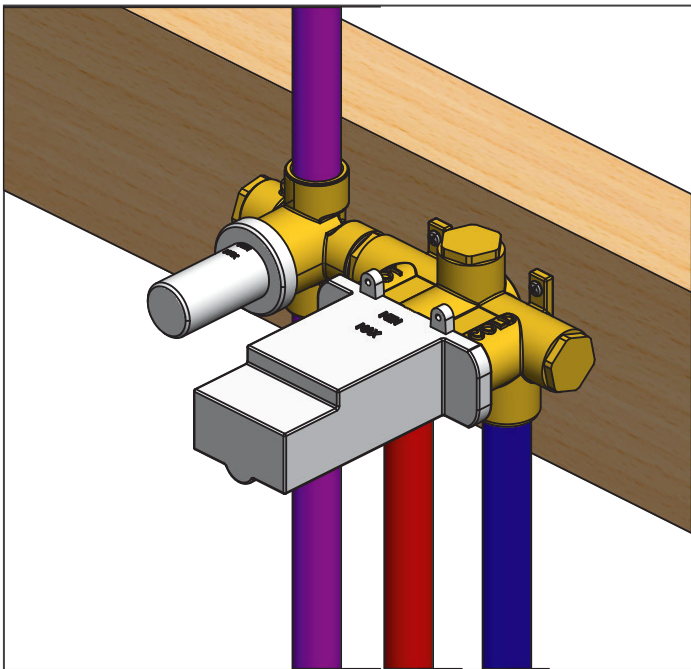

[Horizontal View]

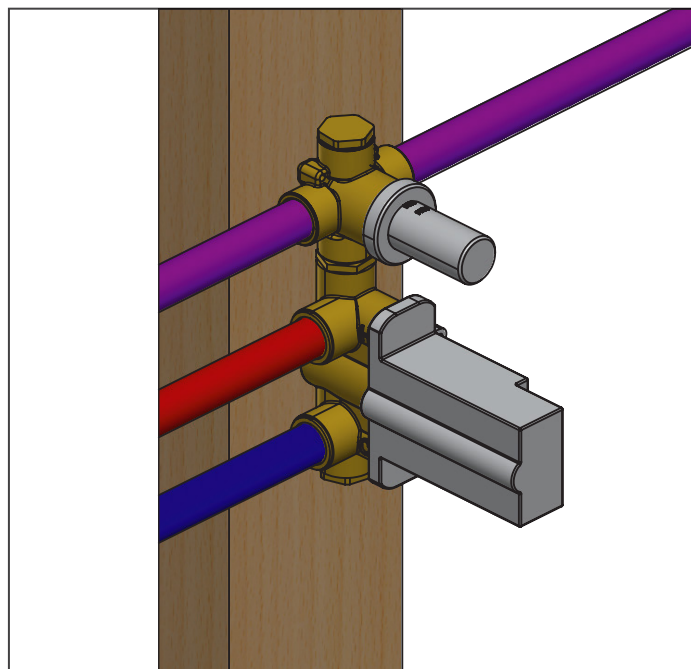

[Vertical View]

TWO OUTPUT CONFIGURATION

VALVE: TVH.2717F

Connect the two output supply lines as seen on the left.

Do not connect any other way.

CONNECTING THE SUPPLY & OUTPUT LINES

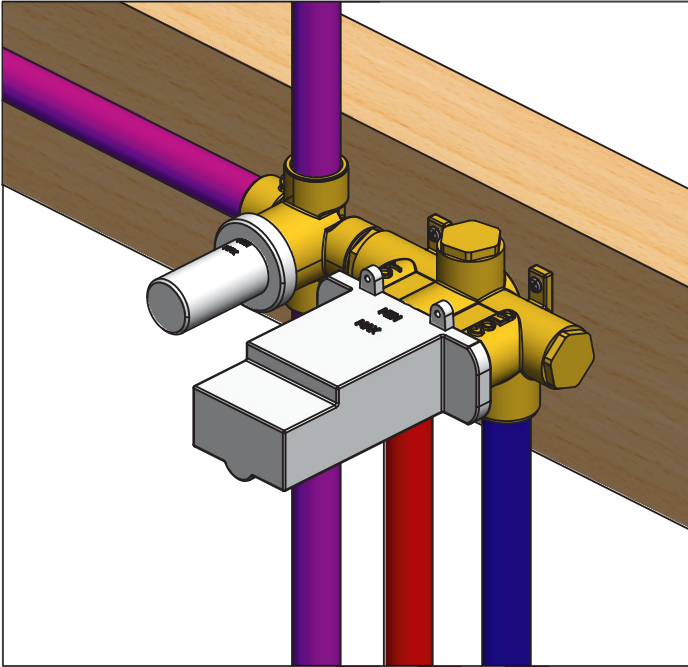

[Horizontal View]

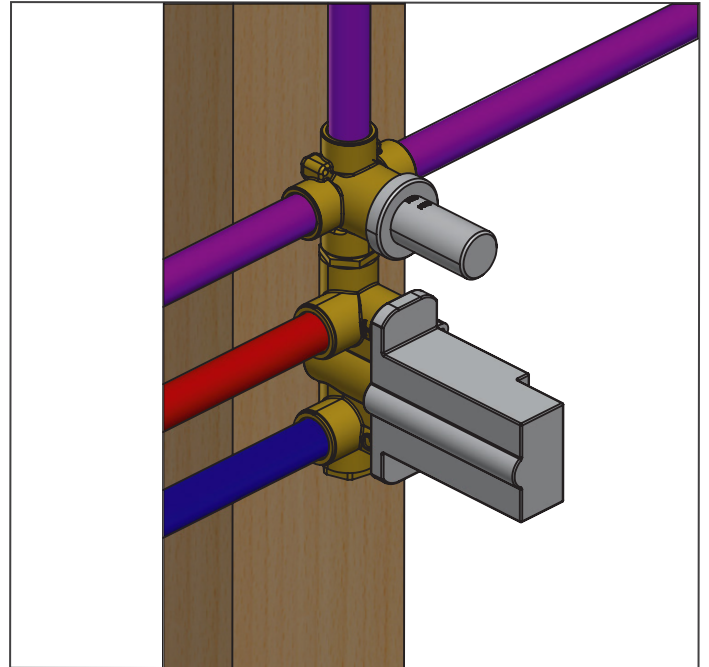

[Vertical View]

THREE OUTPUT CONFIGURATION

VALVE: TVH.2705F

Connect the three output supply lines as seen on the left.

FINISHED TILE POSITION

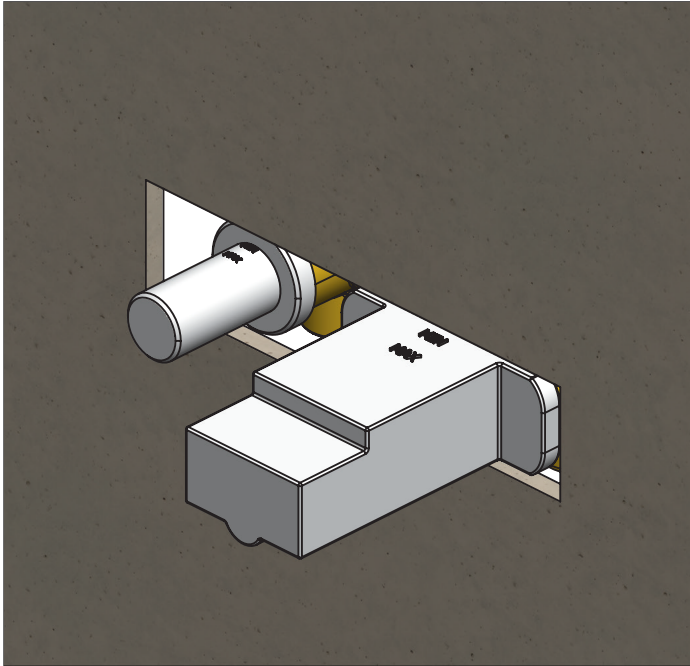

[Horizontal View]

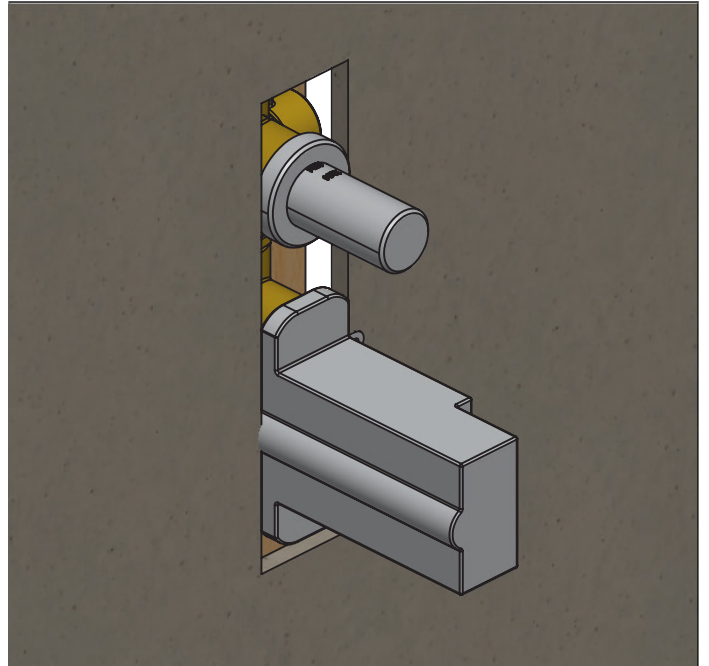

[Vertical View]

Install Drywall and Tile. Ensure finished tile surface is between the min and max marks on the mud guards.

USING THE SUPPLY STOPS

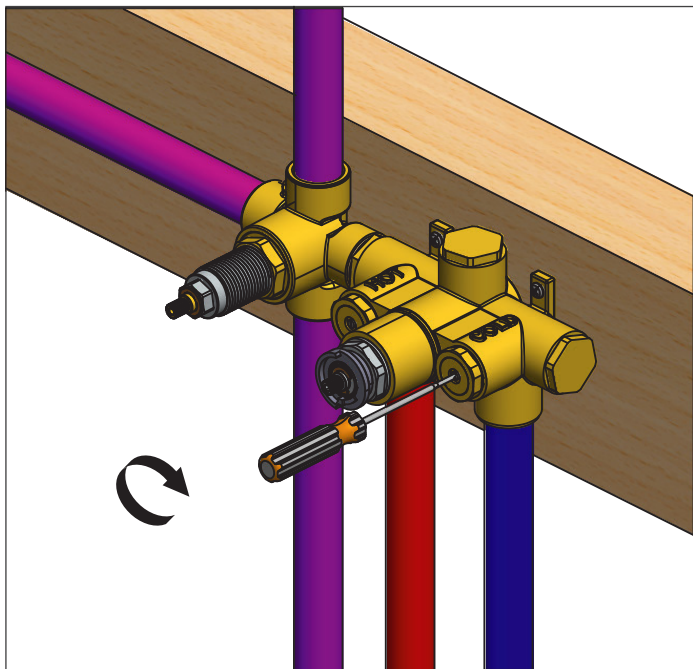

[Horizontal View]

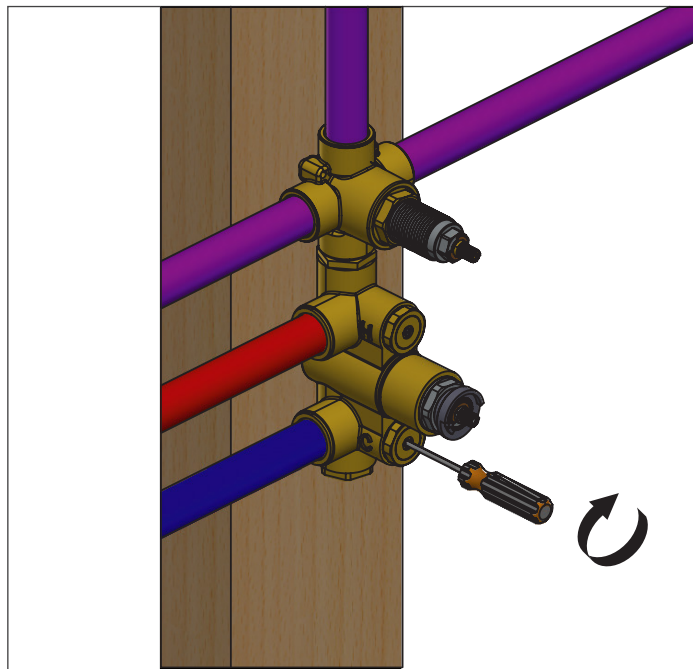

[Vertical View]

Turn Clock-wise 5 times to stop water flow.

[Three output valve version shower here]

FLUSHING THE VALVE

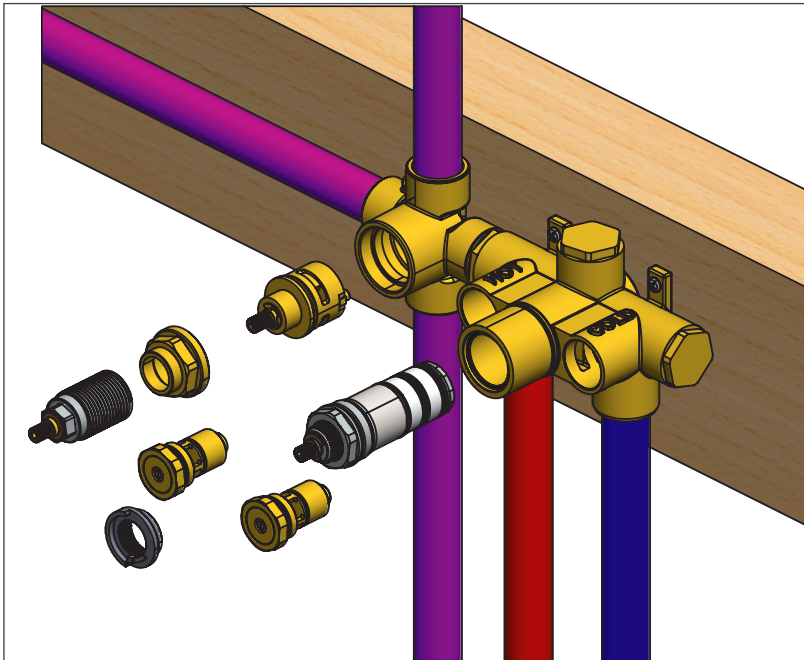

[Horizontal View]

In order to clear dirt in the lines - you must flush the valve before the wall is closed and water is turned on for the first time.

- 1) Remove the 2 supply stops by turning with a spanner
- 2) Remove thermostatic cartridge by turning with a spanner
- 3) Turn on water supply and let water flow removing any dirt in the lines.

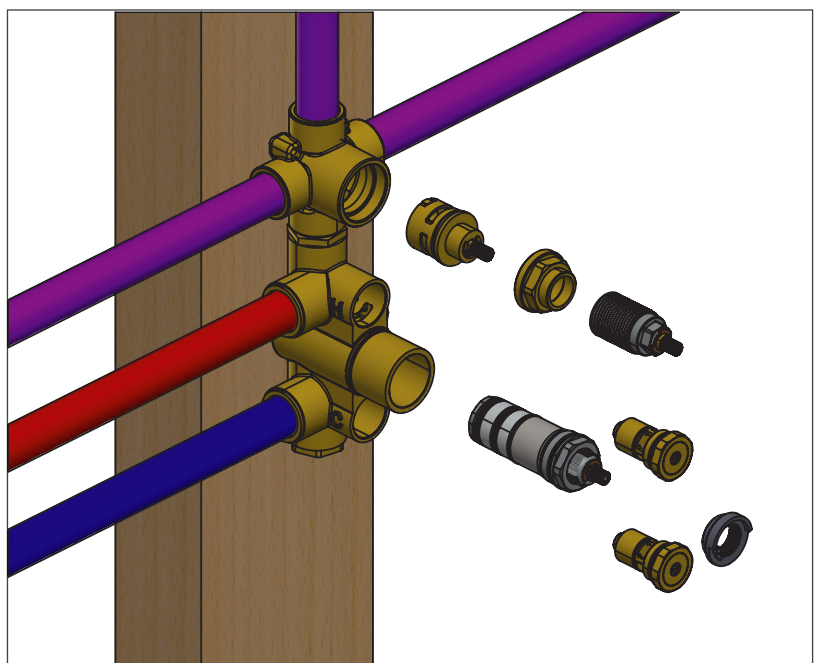

[Vertical View]

INSTALLING THE TRIM - TRIM PLATE SIZE AND SHAPE MAY VARY - ILLUSTRATION ONLY

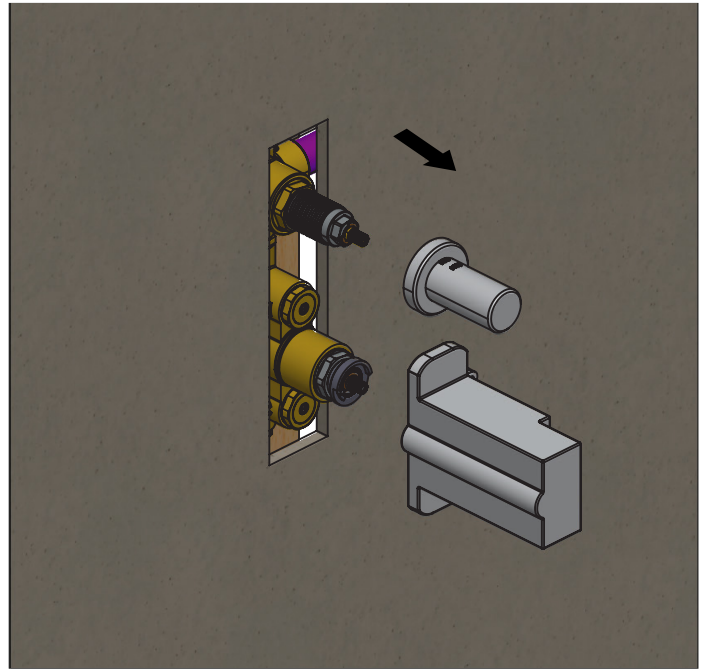
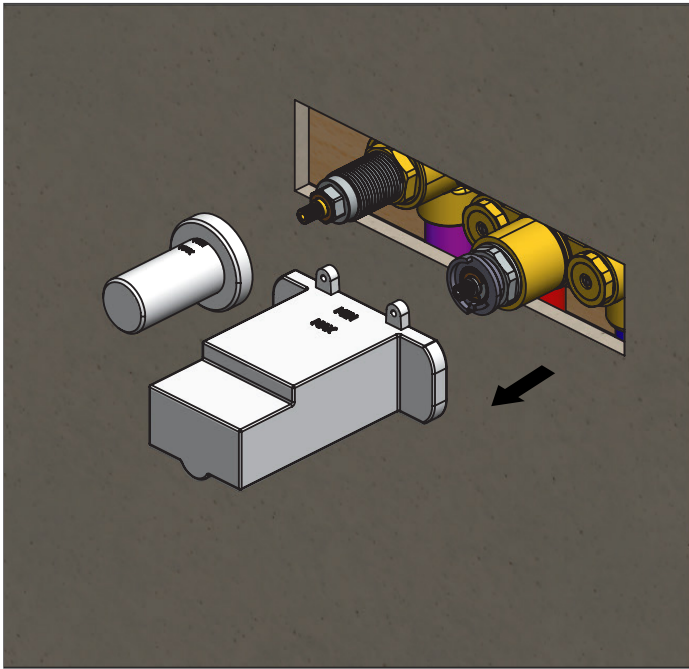

[Horizontal & Vertical View] - Remove mud guards

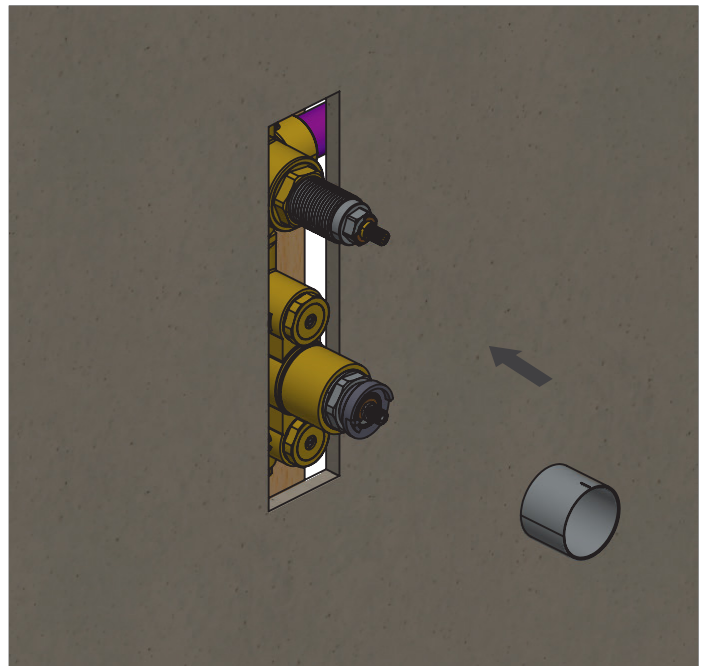
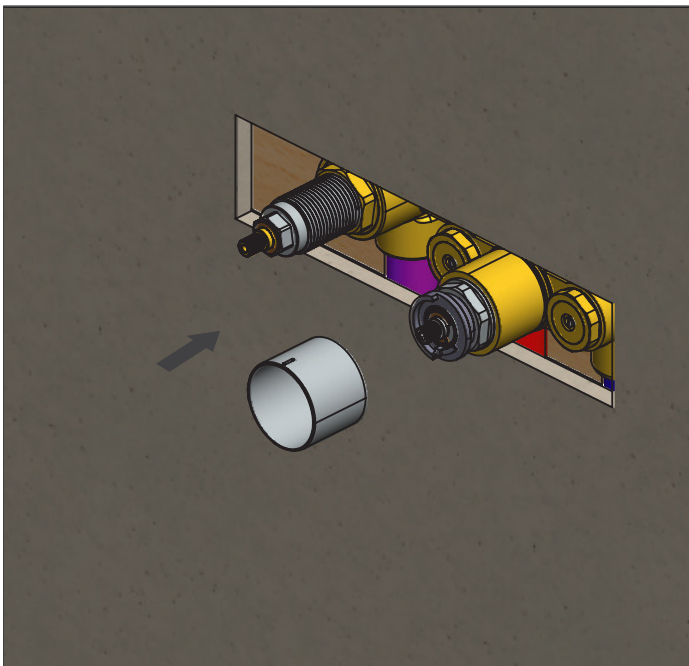

[Horizontal & Vertical View] - Install 42mm ring

INSTALLING THE TRIM - TRIM PLATE SIZE AND SHAPE MAY VARY - ILLUSTRATION ONLY

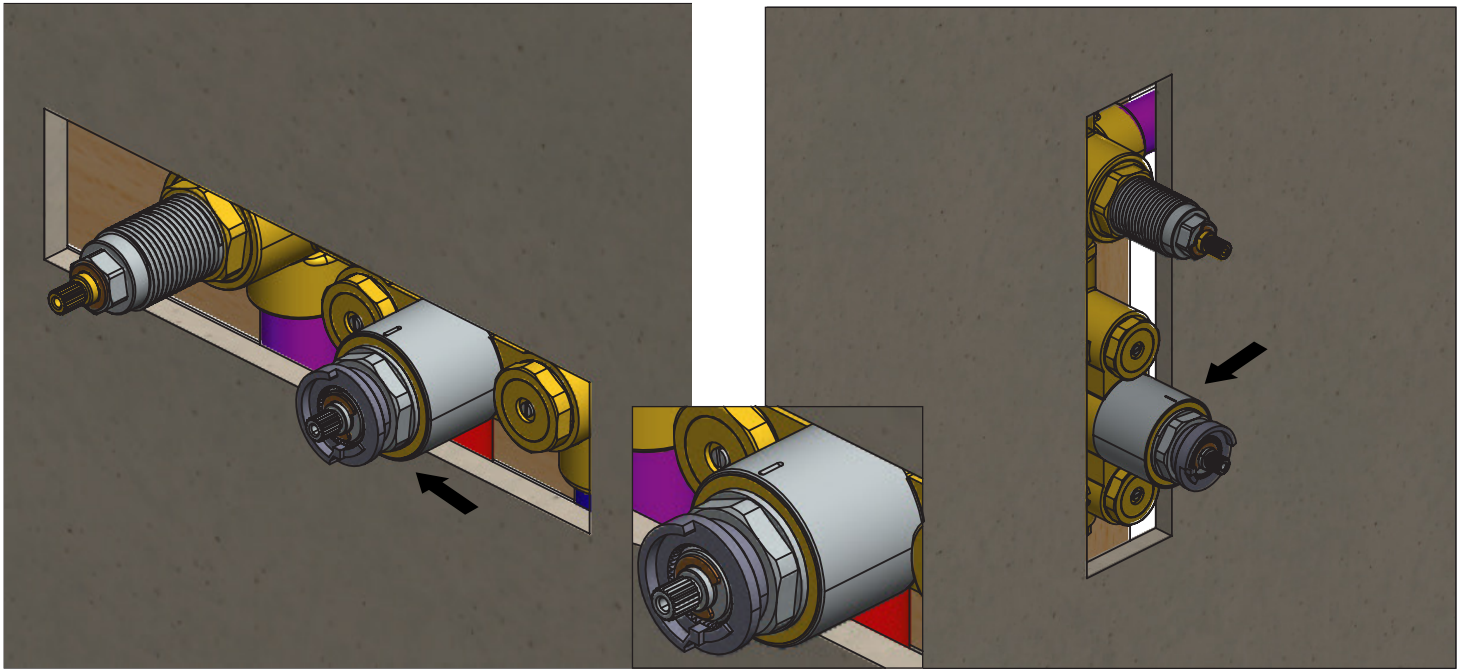

[Horizontal & Vertical View] - A hard push may be required.
The 42mm ring must be flush, otherwise the handle will not fit properly.

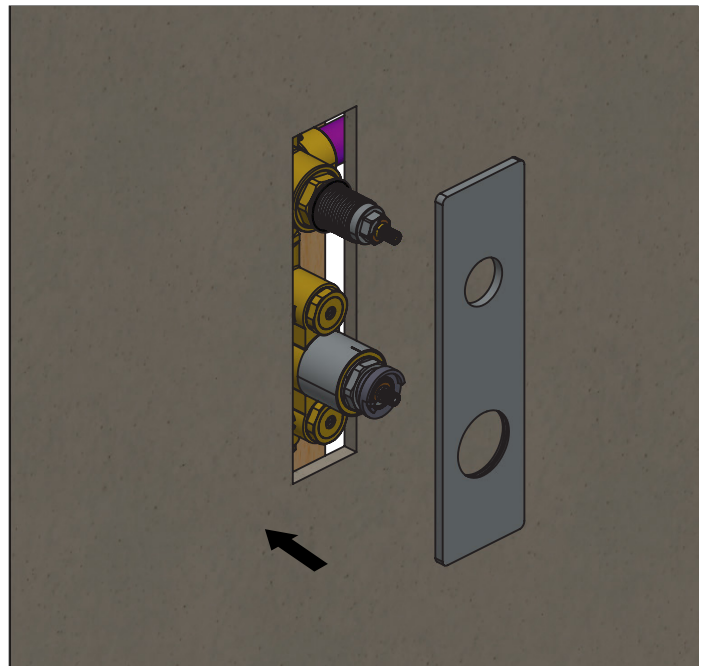
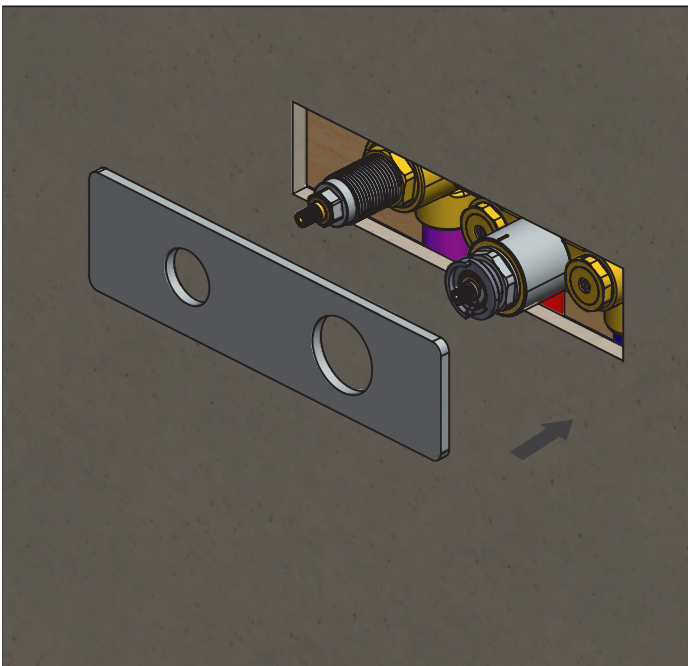

[Horizontal & Vertical View] - Insert Trim

INSTALLING THE TRIM - TRIM PLATE SIZE AND SHAPE MAY VARY - ILLUSTRATION ONLY

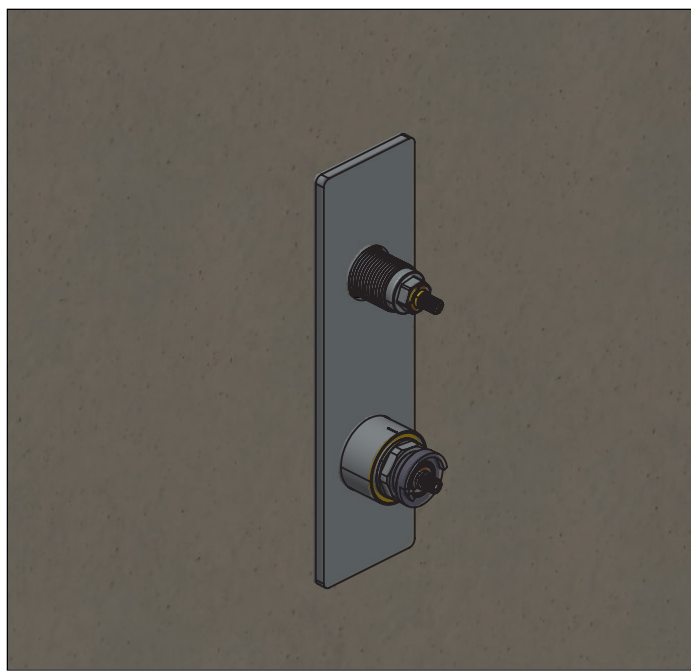
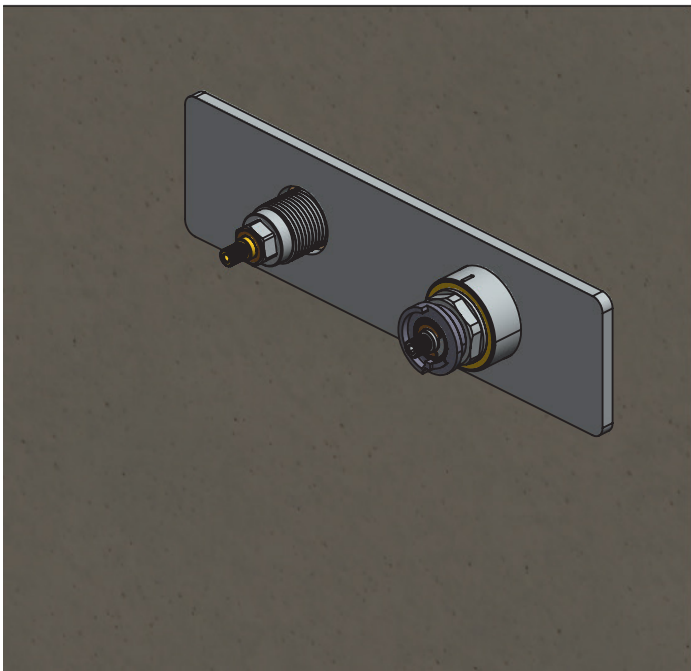

[Horizontal & Vertical View] - Align the trim plate until it is properly positioned.

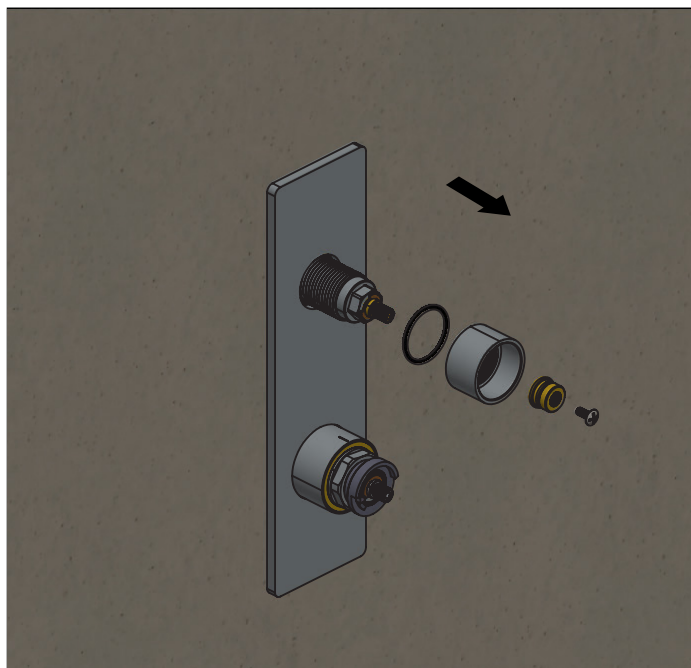
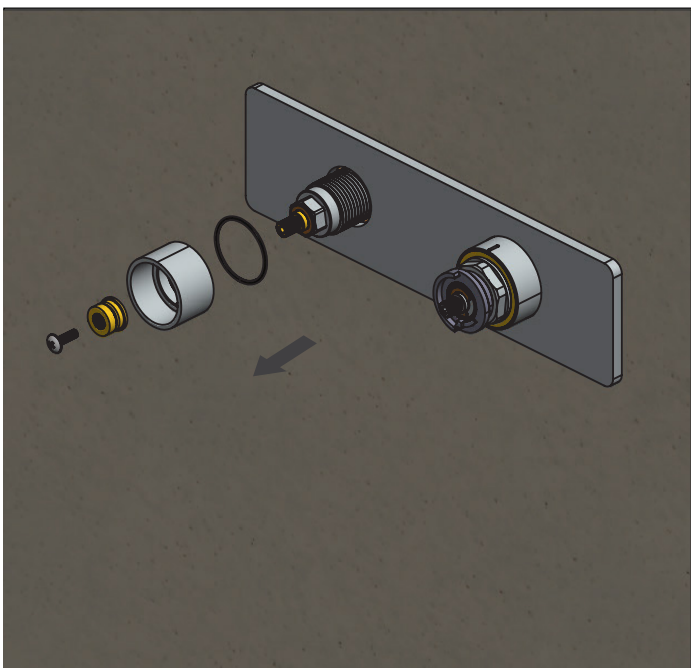

[Horizontal & Vertical View] - Insert the centering knob, screw, and adapter base, then tighten securely.

INSTALLING THE TRIM - TRIM PLATE SIZE AND SHAPE MAY VARY - ILLUSTRATION ONLY

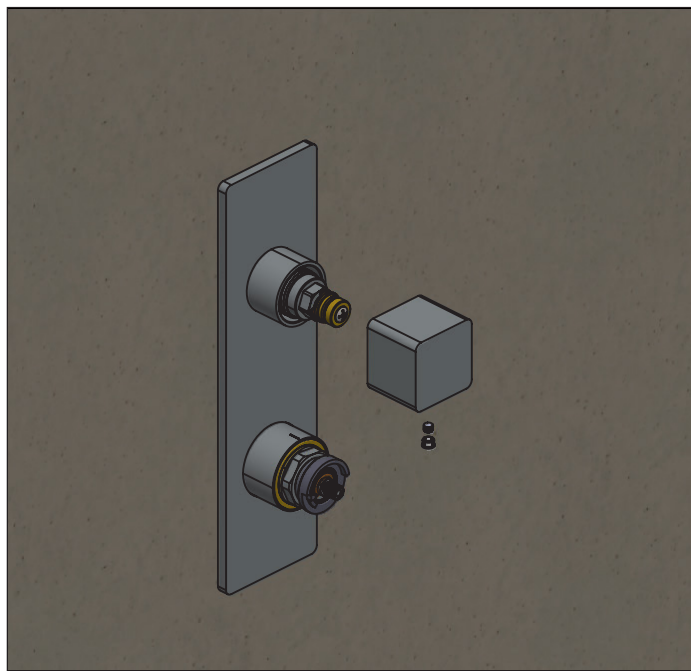
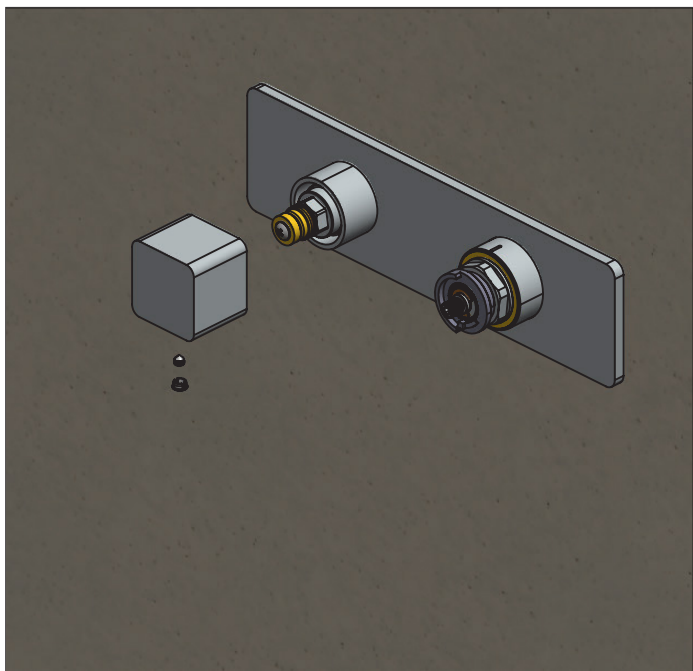

[Horizontal & Vertical View] - Insert the diverter handle, tighten the hex screw, and attach the cover button.

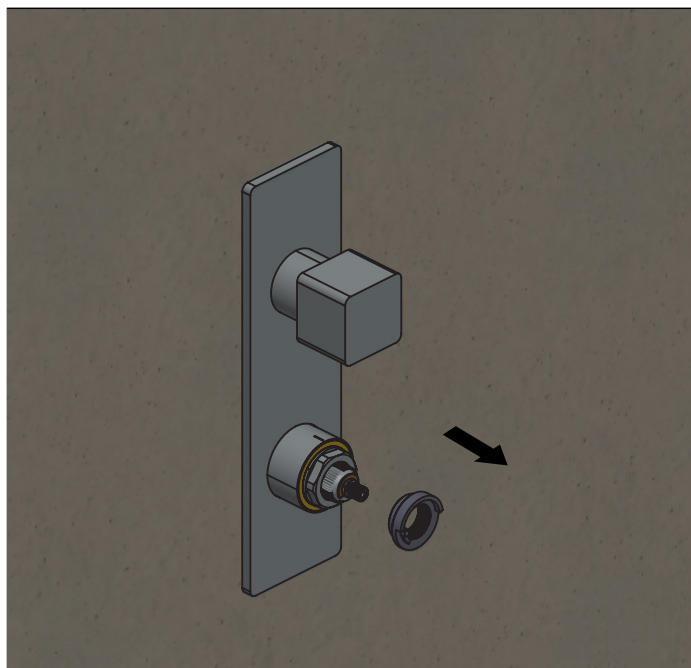
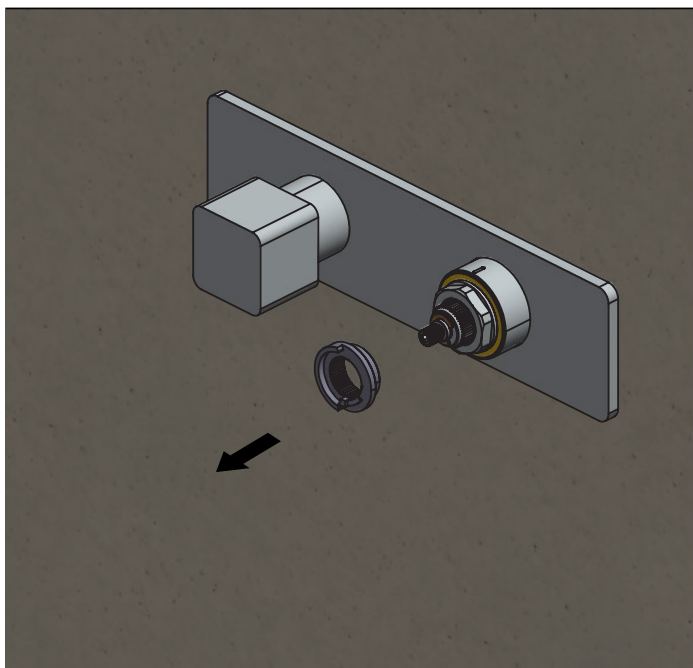

[Horizontal & Vertical View] - Remove anti-scald temperature ring

INSTALLING THE TRIM - TRIM PLATE SIZE AND SHAPE MAY VARY - ILLUSTRATION ONLY

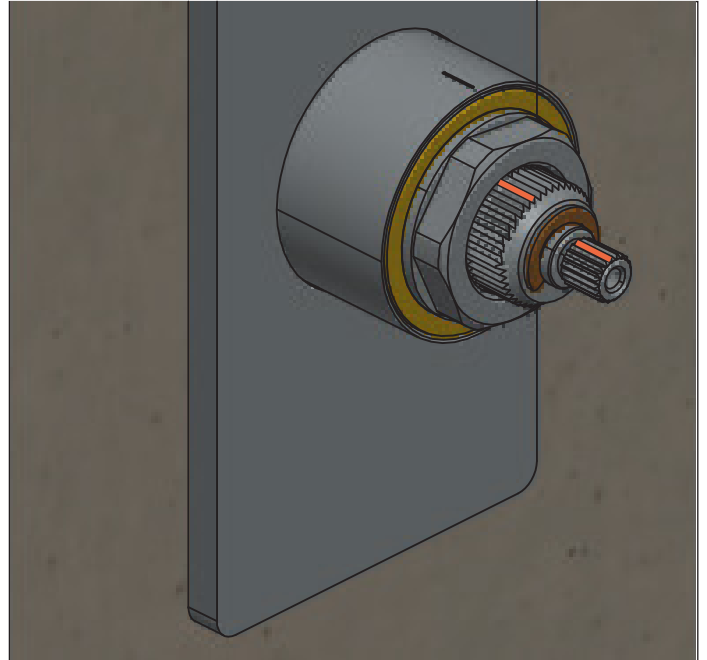
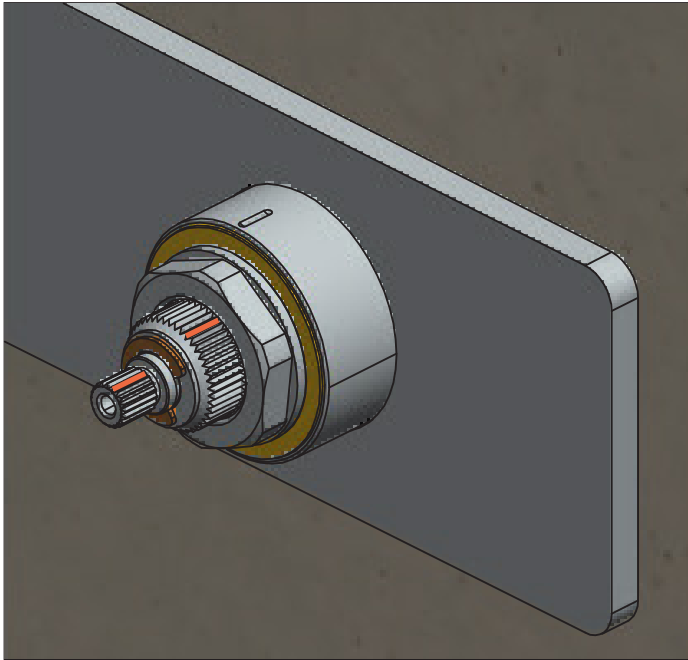

[Horizontal & Vertical View] - Calibrate the cartridge before inserting the temperature handle.
Ensure the red marks are aligned



[Horizontal & Vertical View] - Reinsert the anti-scald temperature ring in the correct position.

INSTALLING THE TRIM - TRIM PLATE SIZE AND SHAPE MAY VARY - ILLUSTRATION ONLY

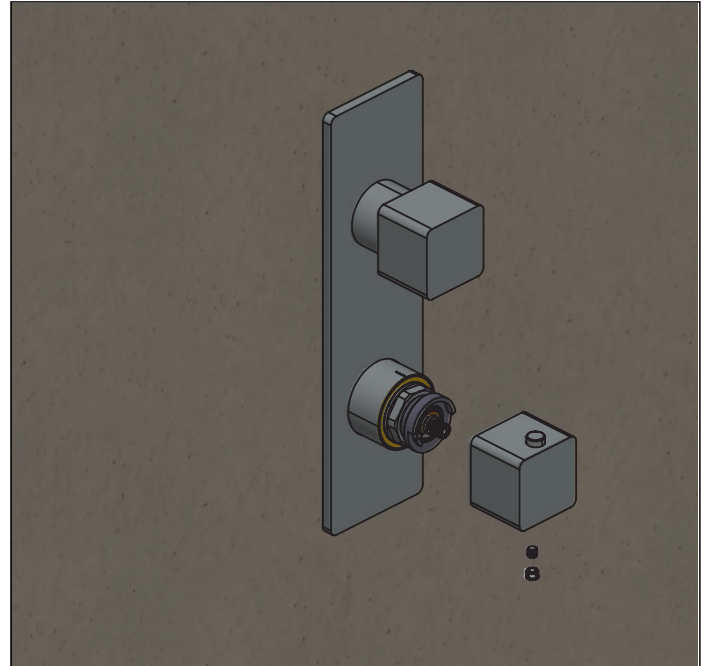
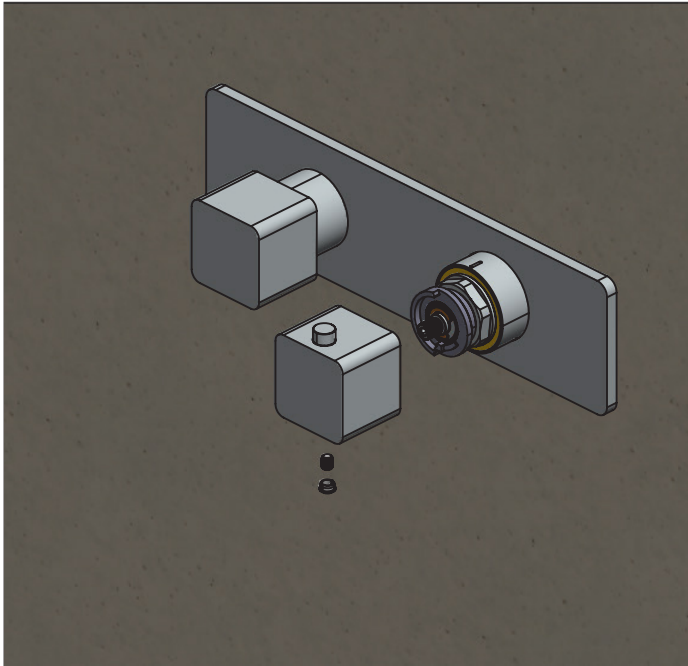

[Horizontal & Vertical View] - Insert the temperature handle, tighten the hex screw, and attach the cover buttons.

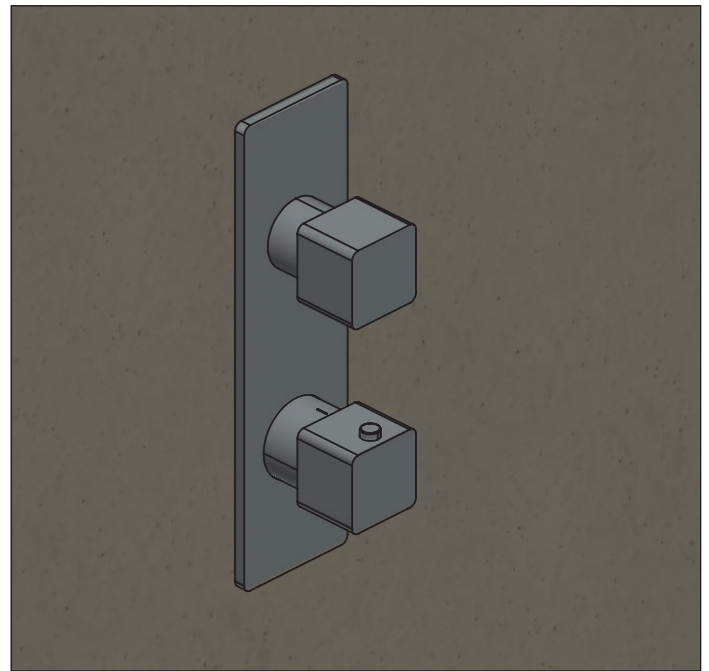
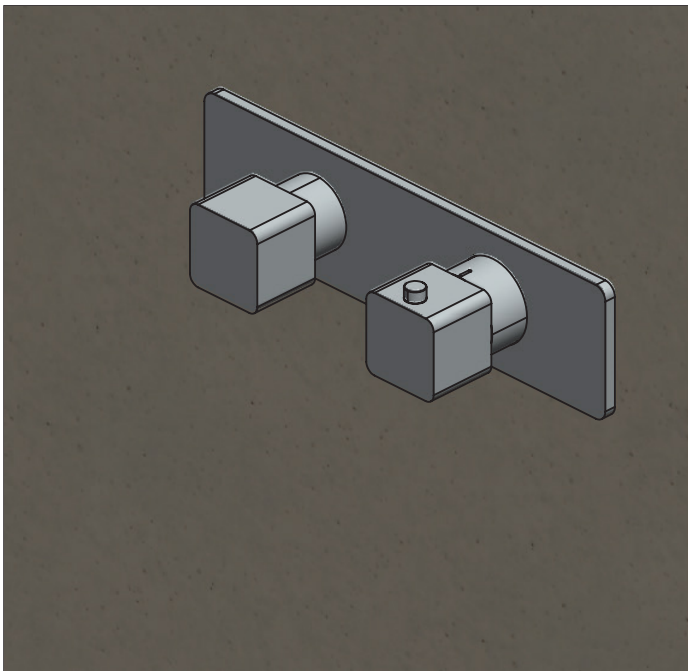

[Horizontal & Vertical View] - This photo shows a fully installed trim, with the temperature control handle featuring an anti-scald button. To increase the water temperature towards "HOT," the button must be pressed

REPLACING THE THERMOSTATIC CARTRIDGE

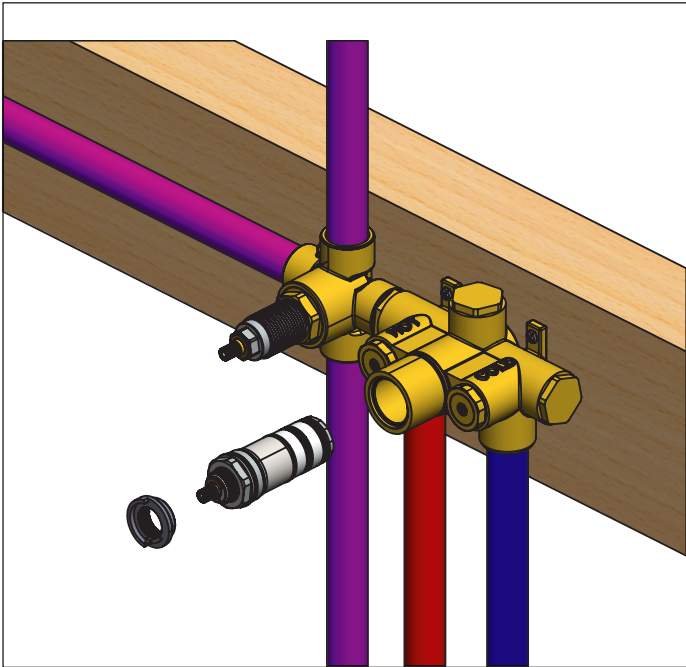

[Horizontal View]

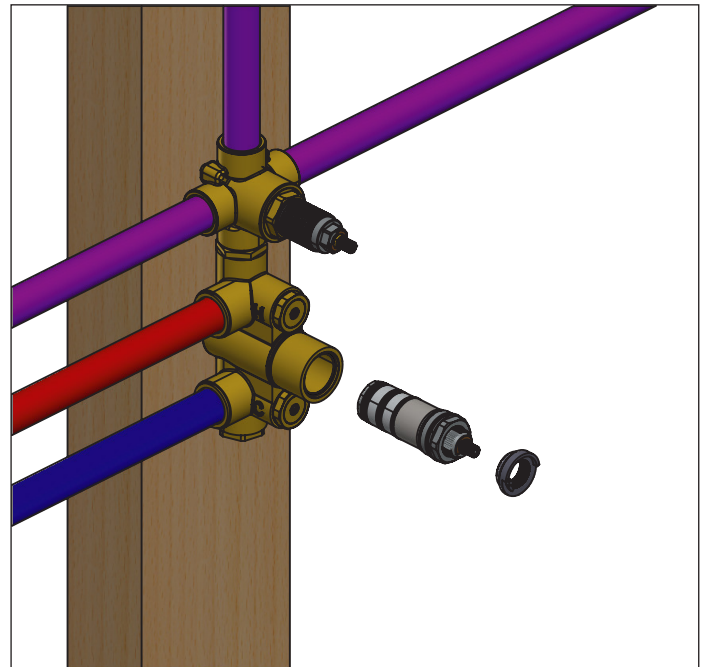

[Vertical View]

1. Remove Anti-Scald Ring
2. The temperature cartridge can be easily removed in a single operation using a spanner.

REPLACING THE DIVERTER CARTRIDGE

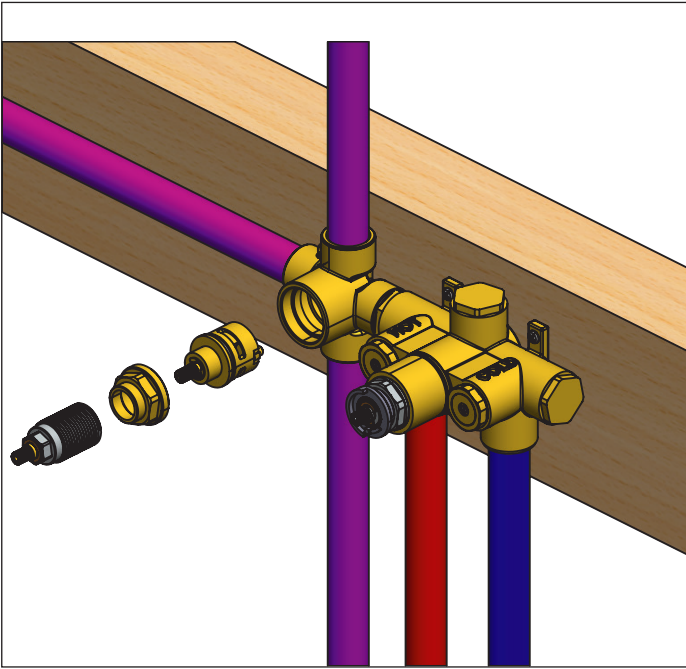

[Horizontal View]

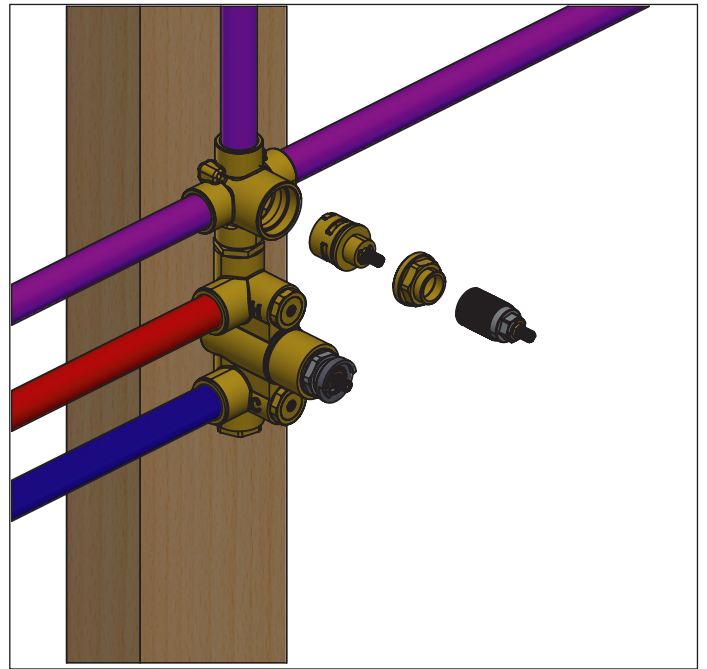

[Vertical View]

1. Remove Threaded Rod using a spanner
2. Remove diverter flange
3. Remove cartridge by turning with a spanner and pulling out with a pair of pliers.

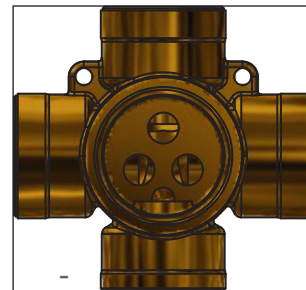

INSTALLING EXTENSIONS TO THE VALVE - OPTIONAL - ACTUAL VALVE MAY VARY

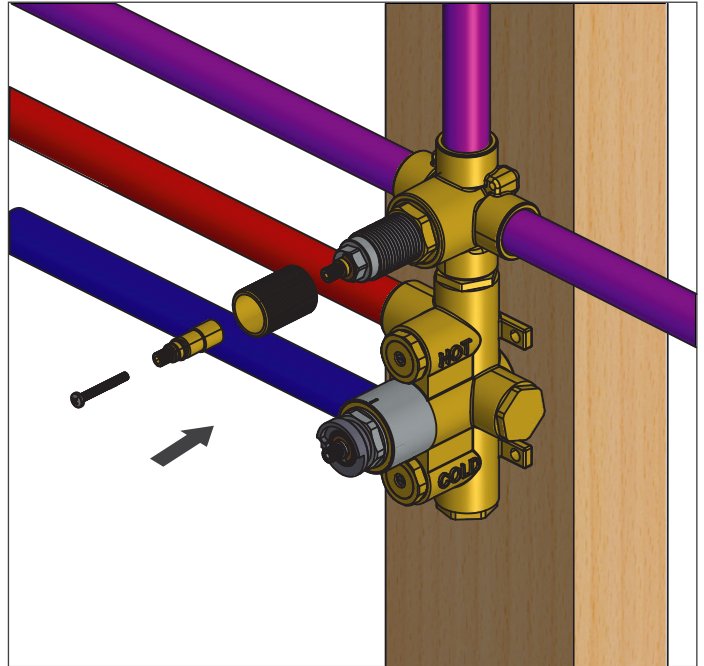
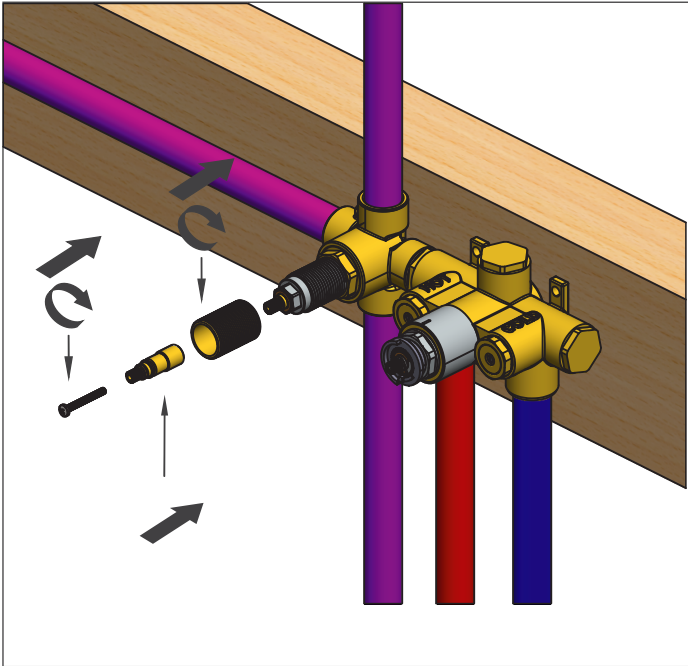

[Horizontal & Vertical View] - Install diverter extension kit - 3 Pieces as shown above

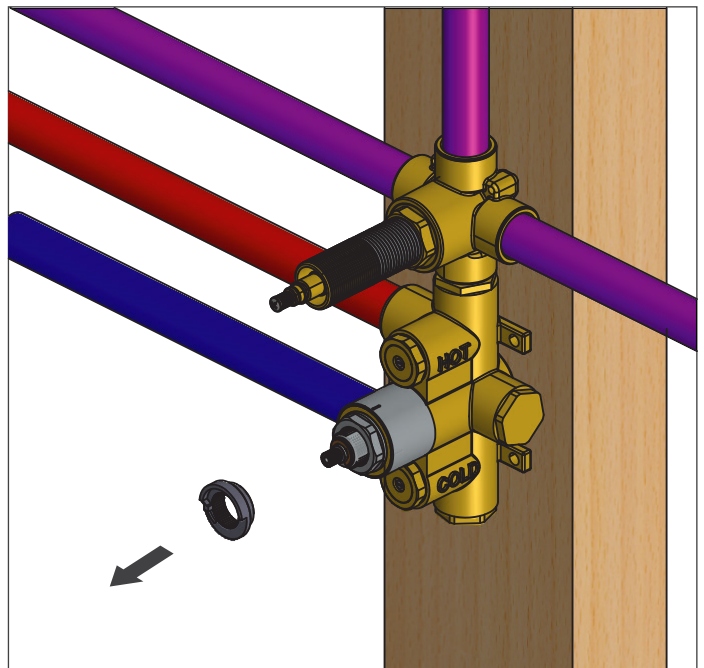
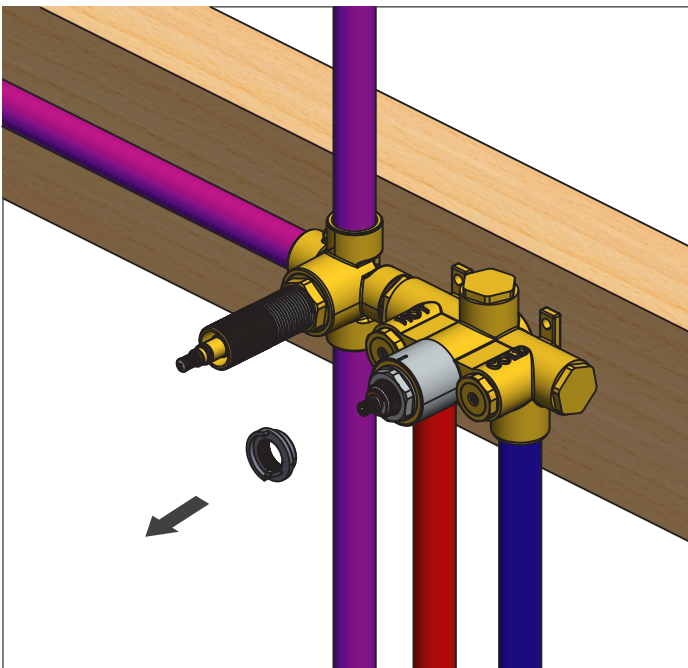

[Horizontal & Vertical View] - Remove anti scald temperature ring

INSTALLING EXTENSIONS TO THE VALVE - OPTIONAL - ACTUAL VALVE MAY VARY

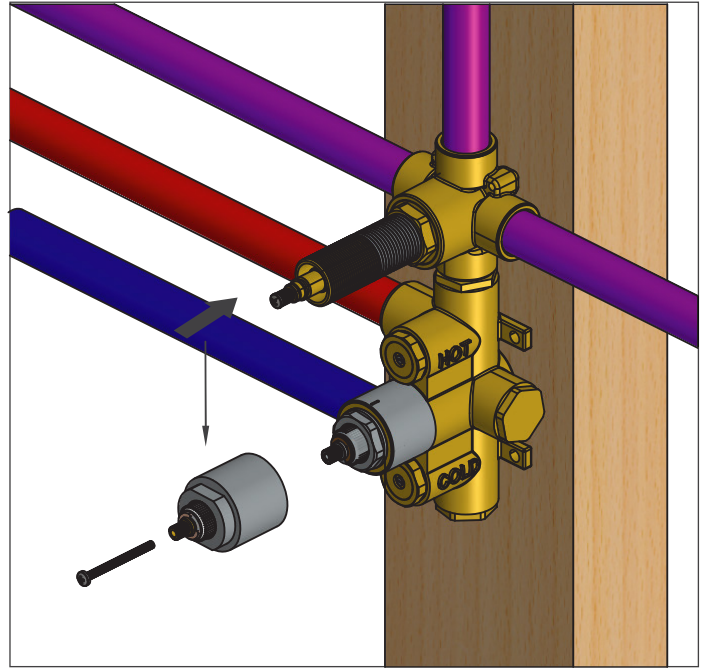
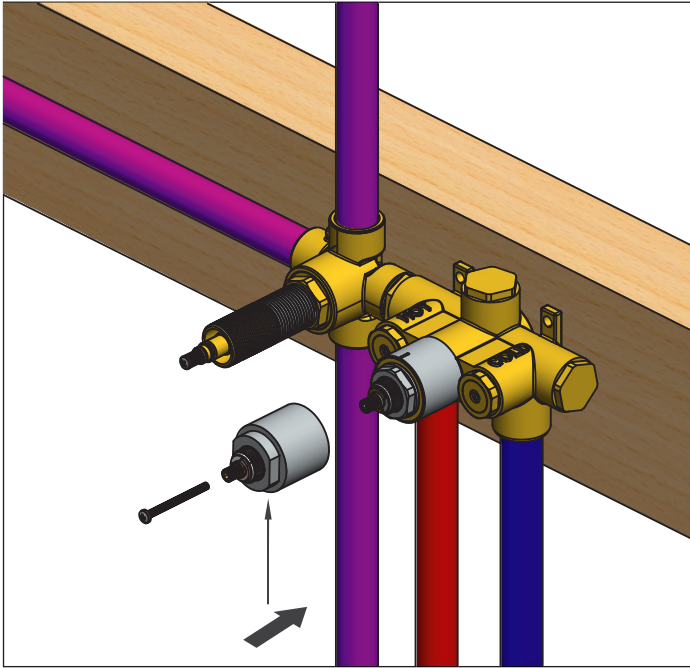

[Horizontal & Vertical View] - Install temperature extension piece as shown above. Tighten Screw

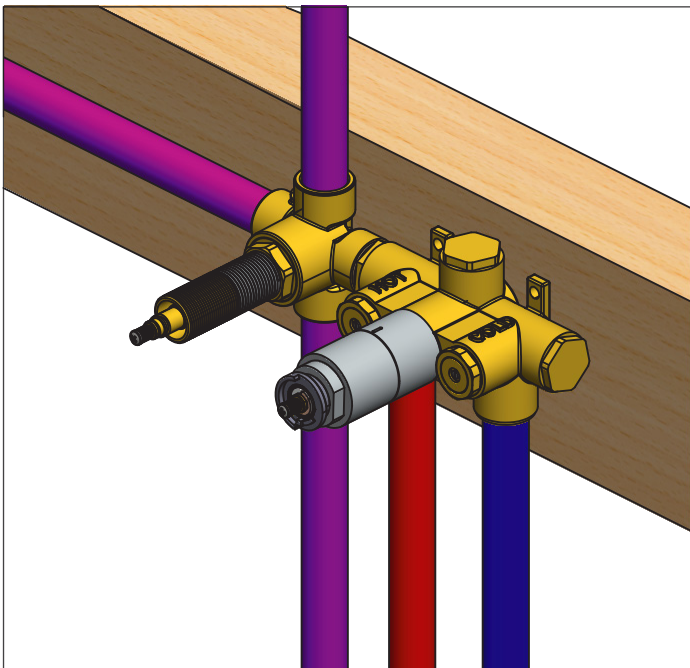

[Horizontal View]

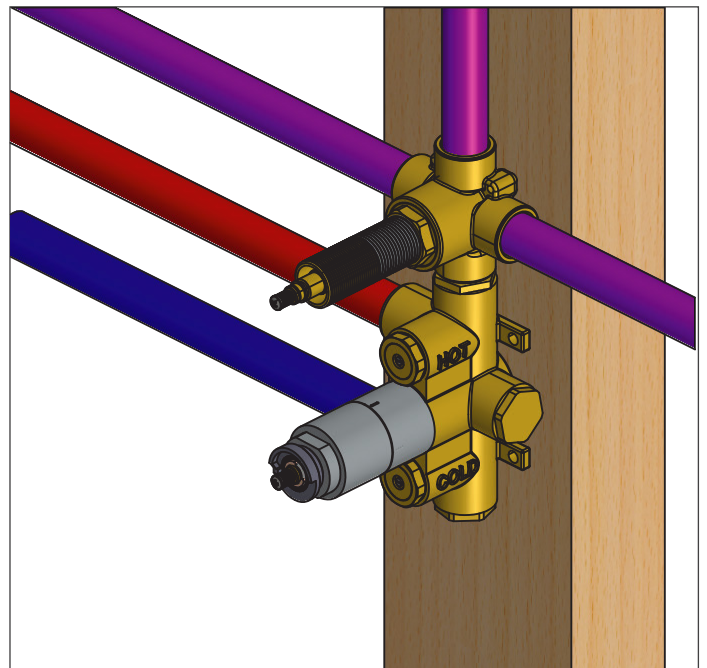

[Vertical View]