

Installation Manual - 1800

[100, 145, 150, 160, 196, 260]

Single Handle Wall Mounted Bathroom Faucet

Use With WLM.1800 Valves

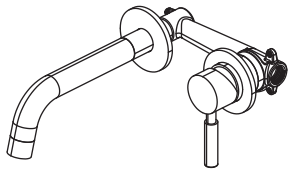

[100.1800T]

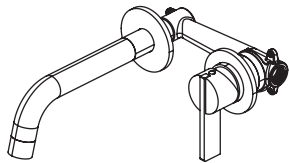

[145.1800T]

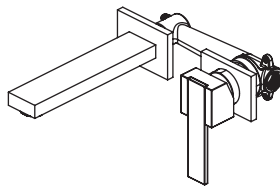

[150.1800T]

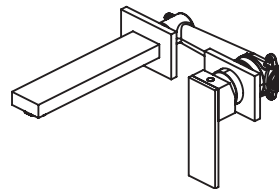

[160.1800T]

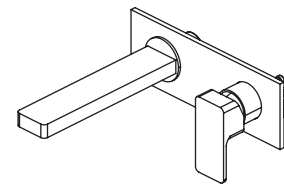

[196.1800T]

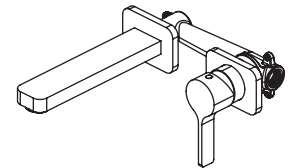

[260.1800T]

BEFORE YOU BEGIN

- You must observe all local plumbing laws and codes.
- Do not install this valve if it does not meet local plumbing codes.
- Shut off the main water supply.

CONNECTING THE SUPPLY & OUTPUT LINES

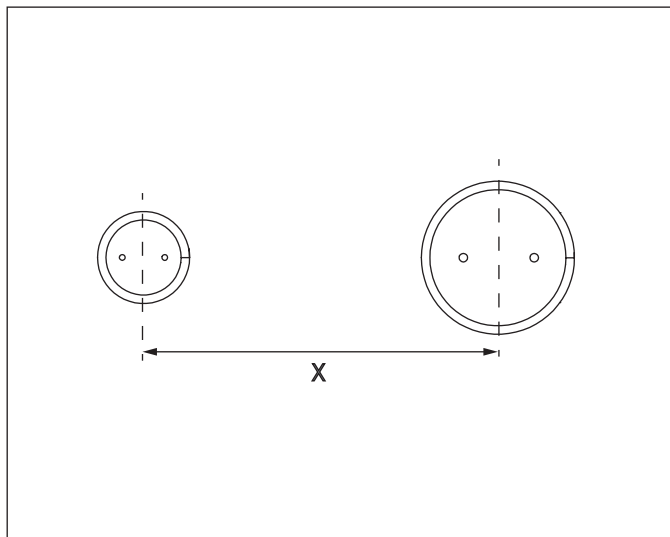

Left Hole $\varnothing = 1.12\text{in}$ [28.5mm], Right Hole $\varnothing = 1.96\text{in}$ [50mm]
Distance Between Holes X - 4.92in [125mm]

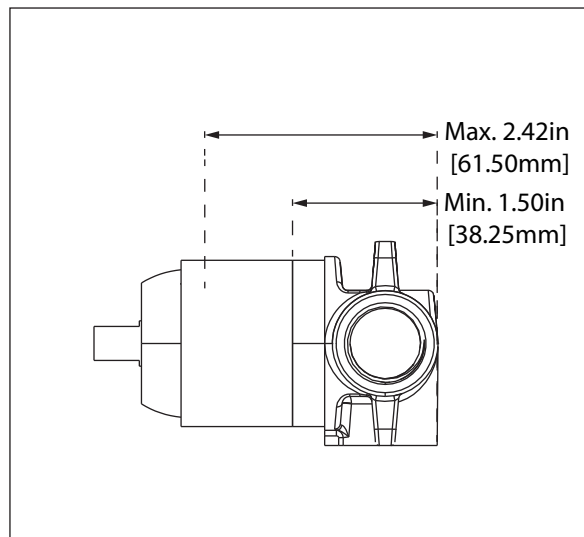

Rough in Specification

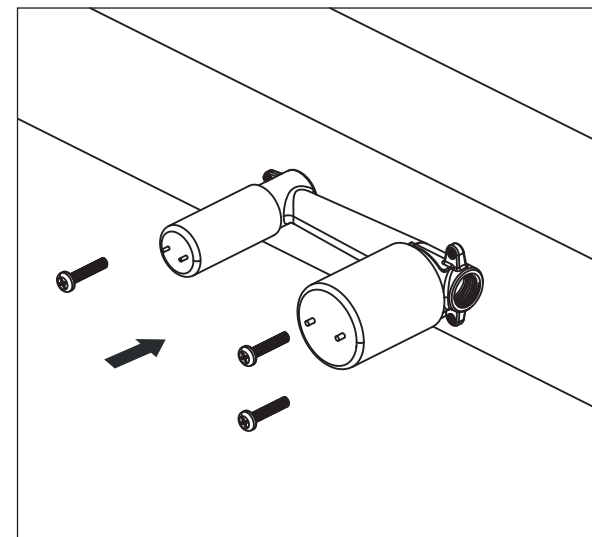

Fix Valve on wooden Plank

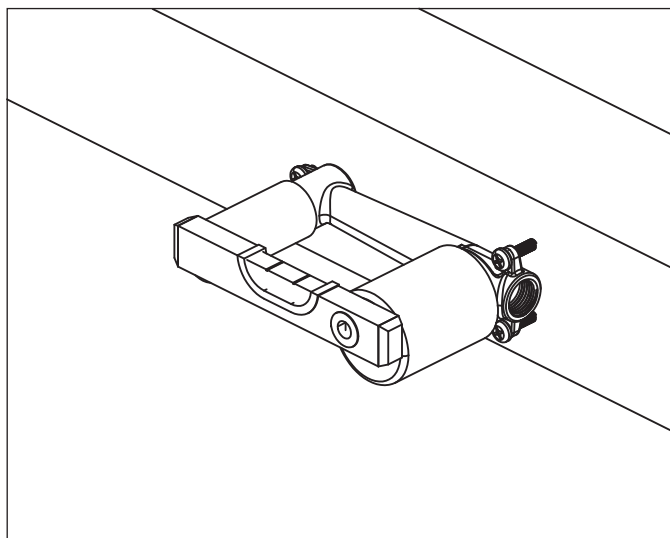

Level Valve

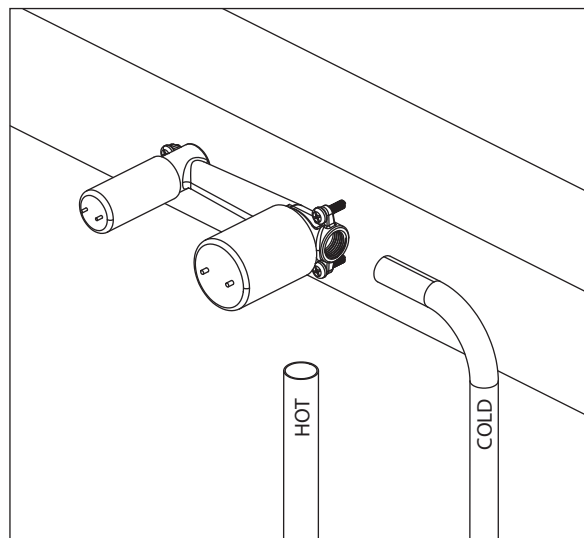

Attach Hot/Cold Supply Lines

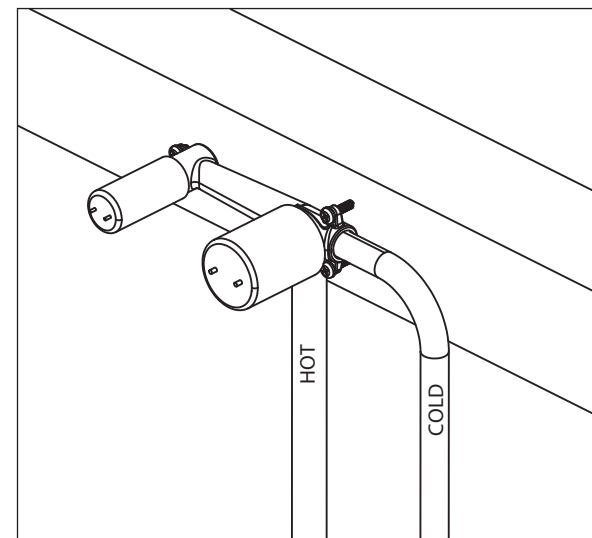

REPLACING THE CARTRIDGE

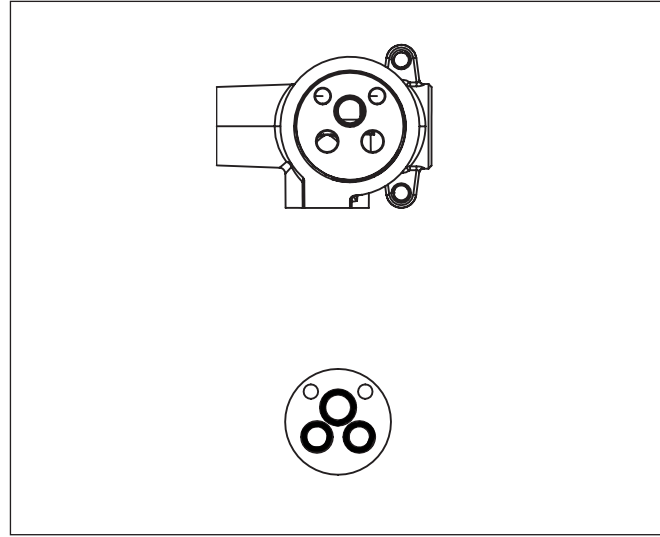
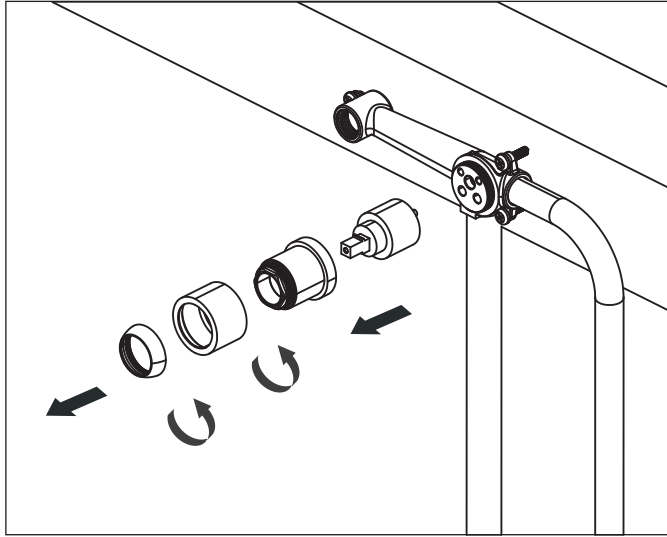

In Order to clear dirt in the line you must flush the valve before the wall is closed and water is turned on for the first time.

- 1) Remove the cartridge
- 2) Remove the output connector
- 3) Turn on water supply and let water flow removing any dirt in the lines.

FLUSHING THE VALVE

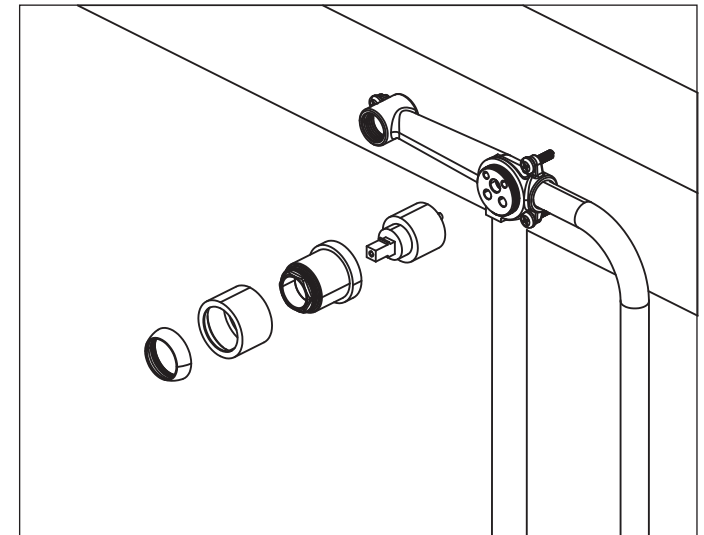

INSTALLING THE TRIM - TRIM PLATE SIZE AND SHAPE MAY VARY - ILLUSTRATION ONLY

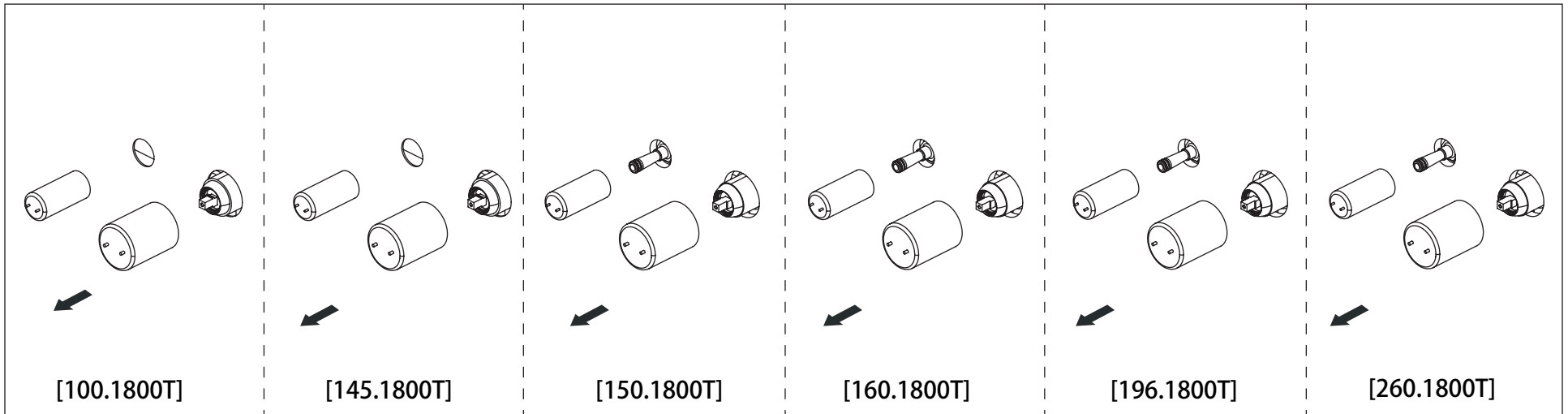

Remove mud guards

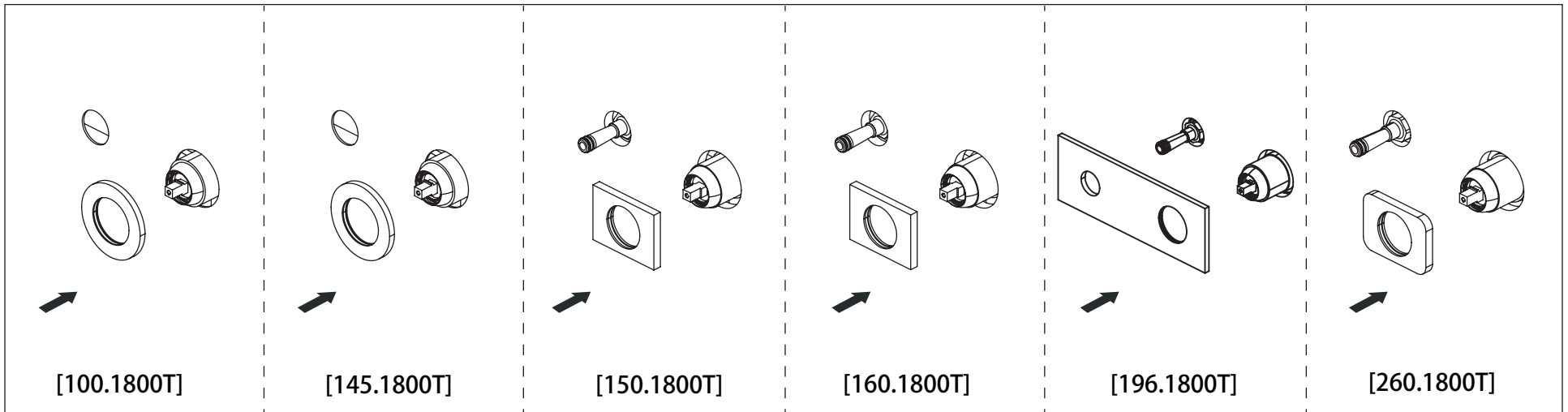

Insert Cartridge Flange.

INSTALLING THE TRIM - TRIM PLATE SIZE AND SHAPE MAY VARY - ILLUSTRATION ONLY

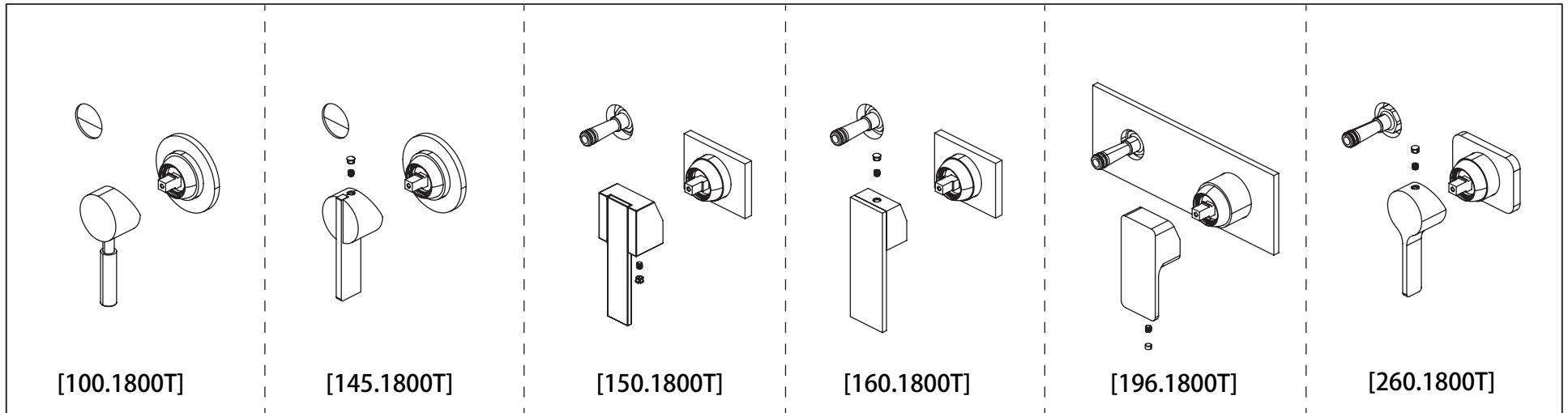

Insert handle and tighten hex screw, Insert Cover button

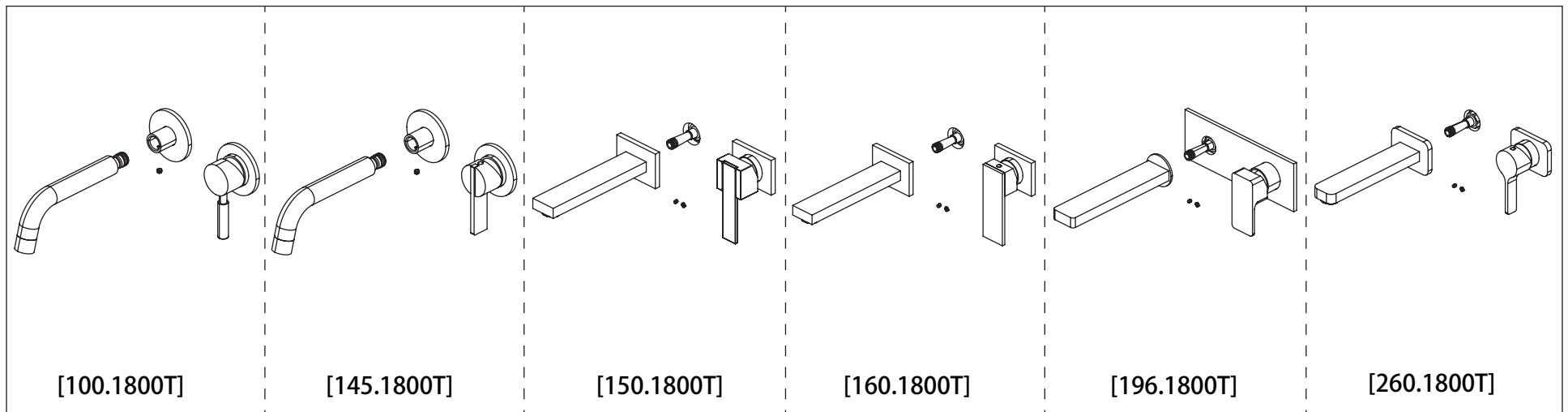

Install the spout and tighten the hex screw to securely fasten it in place.

INSTALLING THE TRIM - TRIM PLATE SIZE AND SHAPE MAY VARY - ILLUSTRATION ONLY

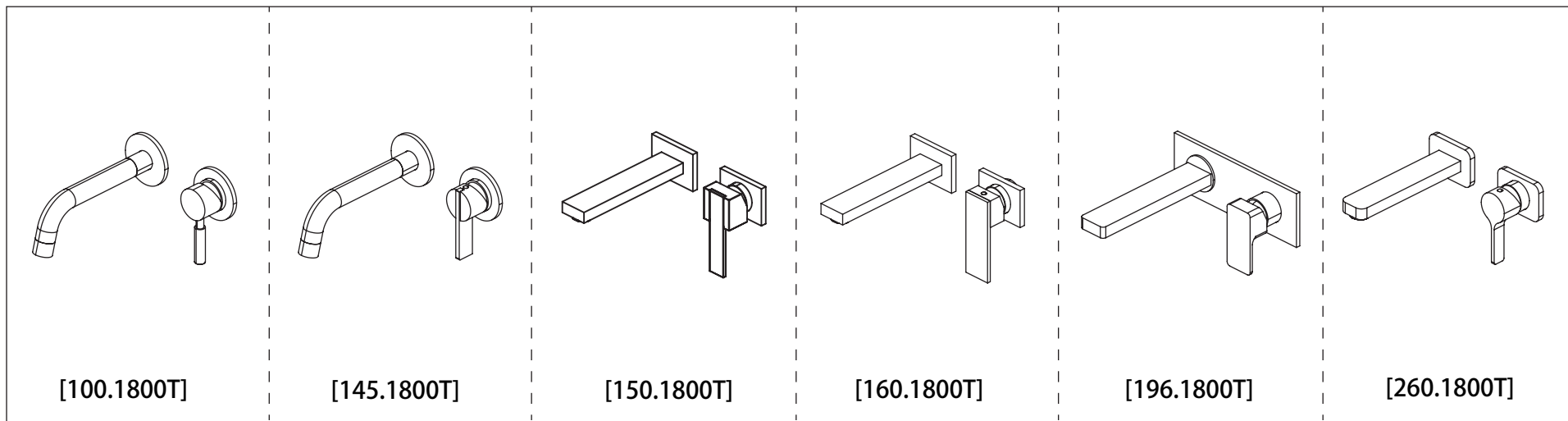

This image depicts a fully installed trim assembly.